

1968

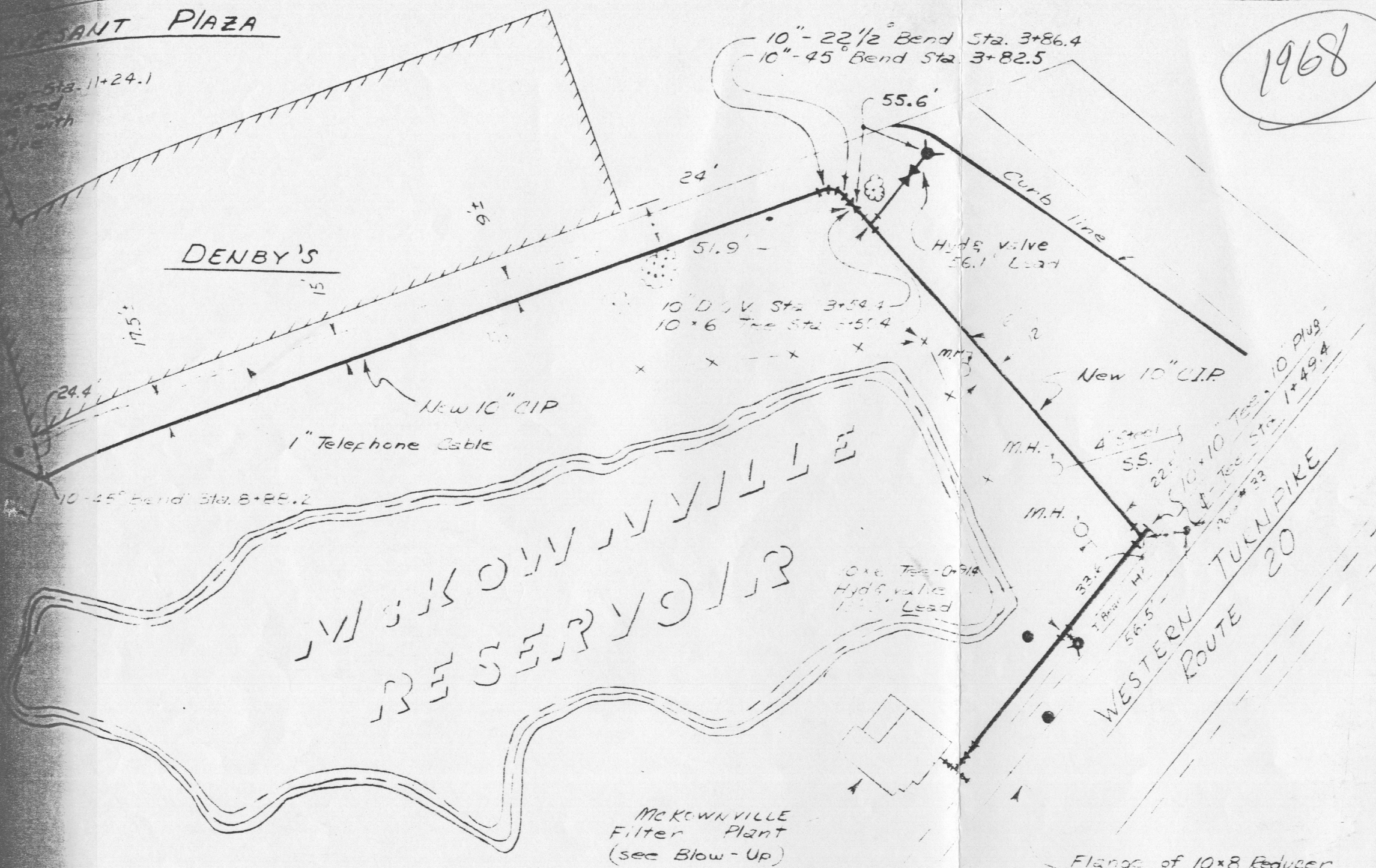

16.4'
16.5'
8" x 10" Reducer
17.7'

MCKOWNVILLE & BIRCHMONT WATER DISTRICTS
 TOWN OF GUILDERLAND
 ALBANY COUNTY NEW YORK
 RECORD PLANS
 SCALE: 1" = 60'
 J. KENNETH FRASER & ASSOCIATES
 CONSULTING ENGINEERS RENSSELAER, NEW YORK
 NOVEMBER 1968