

BUILDING-STRUCTURE INVENTORY FORM

DIVISION FOR HISTORIC PRESERVATION
NEW YORK STATE PARKS AND RECREATION
ALBANY, NEW YORK (518) 474-0479

FOR OFFICE USE ONLY

UNIQUE SITE NO. 001-06-0060
QUAD _____
SERIES _____
NEG. NO. _____

YOUR NAME: Town of Guilderland DATE: June 1, 1979

YOUR ADDRESS: Town Hall Guilderland TELEPHONE: 518-365-1980
N.Y.

ORGANIZATION (if any): _____

(Guilderland MRA)

IDENTIFICATION

1. BUILDING NAME(S): Veeder Farmhouse #2 -(Building #19)
2. COUNTY: Albany TOWN/CITY: Guilderland VILLAGE: _____
3. STREET LOCATION: 3858 Western Tpke.
4. OWNERSHIP: a. public ☐ b. private ☒
5. PRESENT OWNER: Donald J. Miletich ADDRESS: 3858 Western Tpke. R.D. Altamont,
N.Y. 12009
6. USE: Original: Farmhouse Present: residence
7. ACCESSIBILITY TO PUBLIC: Exterior visible from public road: Yes ☒ No ☐
Interior accessible: Explain by appointment

DESCRIPTION

8. BUILDING MATERIAL: a. clapboard ☒ b. stone ☐ c. brick ☐ d. board and batten ☐
e. cobblestone ☐ f. shingles ☐ g. stucco ☐ other: _____
9. STRUCTURAL SYSTEM: a. wood frame with interlocking joints ☒
(if known) b. wood frame with light members ☐
c. masonry load bearing walls ☐
d. metal (explain) _____
e. other _____
10. CONDITION: a. excellent ☐ b. good ☒ c. fair ☐ d. deteriorated ☐
11. INTEGRITY: a. original site ☒ b. moved ☐ if so, when? _____
c. list major alterations and dates (if known): _____

12. PHOTO:



HP-1

13. MAP:

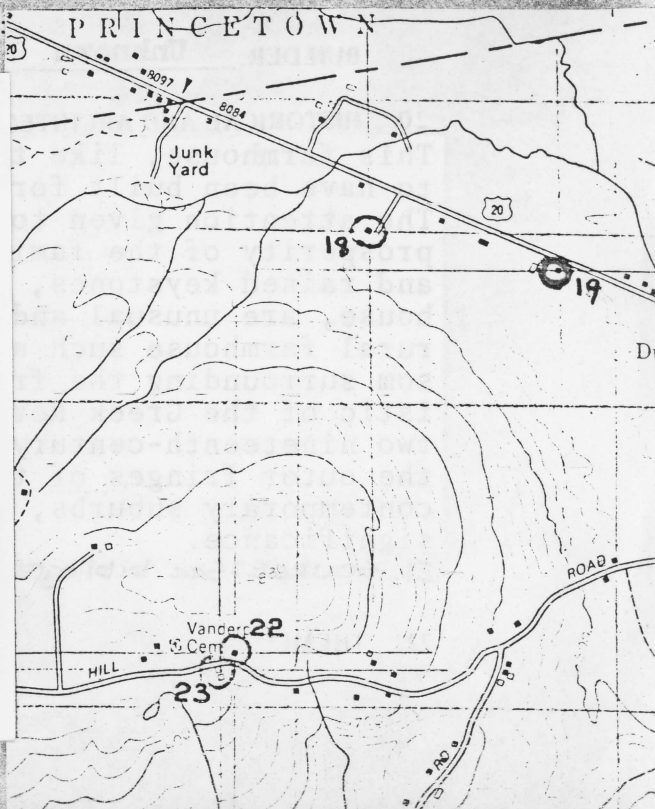

APR • 72

14. THREATS TO BUILDING: a. none known ☒ b. zoning ☐ c. roads ☐
d. developers ☐ e. deterioration ☐
f. other: _____
15. RELATED OUTBUILDINGS AND PROPERTY:
a. barn ☐ b. carriage house ☐ c. garage ☒ (Not historic)
d. privy ☐ e. shed ☐ f. greenhouse ☐
g. shop ☐ h. gardens ☐
i. landscape features: _____
j. other: _____
16. SURROUNDINGS OF THE BUILDING (check more than one if necessary):
a. open land ☒ b. woodland ☐
c. scattered buildings ☒
d. densely built-up ☐ e. commercial ☐
f. industrial ☐ g. residential ☒
h. other: _____

17. INTERRELATIONSHIP OF BUILDING AND SURROUNDINGS:
(Indicate if building or structure is in an historic district)

Farmhouse is located close to heavily traveled Western Turnpike (U.S. 20) and "sister" house is located to the west.

18. OTHER NOTABLE FEATURES OF BUILDING AND SITE (including interior features if known):

Two-story Greek Revival farmhouse on cut stone foundation; unusual carved wooden lintels with Greek key design; paneled frieze and cornice with modillions, one-story ell on rear of house; classical recessed entrance with paneled door, transom, side lights and pilasters; paired lunettes in gable ends.

SIGNIFICANCE

19. DATE OF INITIAL CONSTRUCTION: ca. 1830

ARCHITECT: Unknown

BUILDER: Unknown

20. HISTORICAL AND ARCHITECTURAL IMPORTANCE:

This farmhouse, like the one at 3770 Western Turnpike, is believed to have been built for members of the prominent Veeder family. The attention given to detail in this rural building reflects the prosperity of the family. Window surrounds with simple fretwork and raised keystones, somewhat similar to those on the other Veeder house, are unusual and particularly significant on an isolated, rural farmhouse such as this. Sidelights, columns, a transom surrounding the front door and corner pilasters are characteristic of the Greek Revival style. The building is one of only two nineteenth-century houses built along the Western Turnpike on the outer fringes of the town. Relative to its surroundings of contemporary suburbs, the building is of exceptional architectural significance.

21. SOURCE: See bibliography

22. THEME:

3858 Western Turnpike

Building # 19

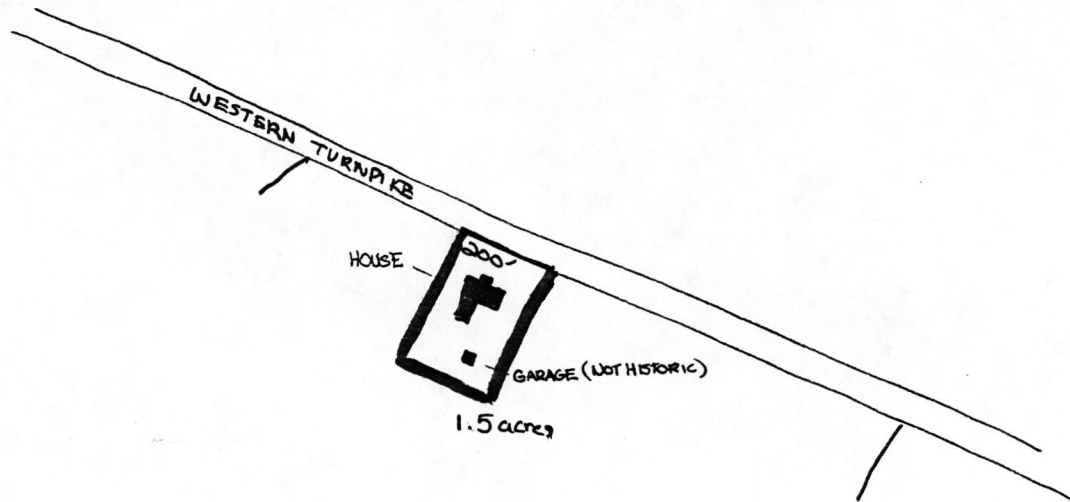

1" = 400'

Veeder Farmhouse #2
Historic Resources of
Guilderland Phase I
Albany County Guilderland
New York
Site Map (from tax map)
Smith & Mahoney 1979

N ↑

United States Department of the Interior
National Park Service

National Register of Historic Places
Inventory—Nomination Form

OMB NO. 1024-0018

EXP. 12/31/84

For NPS use only

received

date entered

Continuation sheet

Item number

Page 3 of 4

Multiple Resource Area
Thematic Group

Name Guilderland Multiple Resource Area
State New York

Nomination/Type of Review

Date/Signature

21. St. Mark's Lutheran Church
Entered in the
National Register

for Keeper

Delores Byers 11/10/82

Attest

22. Prospect Hill Cemetery
Building
Entered in the
National Register

for Keeper

Delores Byers 11/10/82

Attest

23. Fuller's Tavern
Entered in the
National Register

for Keeper

Delores Byers 11/10/82

Attest

24. Veeder Farmhouse #1
Entered in the
National Register

for Keeper

Delores Byers 11/10/82

Attest

25. Veeder Farmhouse #2
Substantive Review

Keeper

Anna Lee Douglas 11/10/82

Attest

26. Van Patten Barn Complex
Entered in the
National Register

for Keeper

Delores Byers 11/10/82

Attest

27. Gillespie House
Entered in the
National Register

for Keeper

Delores Byers 11/10/82

Attest

28. Sharp Brothers House
Entered in the
National Register

for Keeper

Delores Byers 11/10/82

Attest

29. Sharp Farmhouse
Entered in the
National Register

for Keeper

Delores Byers 11/10/82

Attest

30. Parker, Charles, House
Substantive Review

Keeper

Anna Lee Douglas 11/10/82

Attest

United States Department of the Interior
National Park Service Substantive Review

Veeder Farmhouse #2 (Guilderland MRA)
Albany County
NEW YORK

Working No. 969/82-2682
Fed. Reg. Date: 2.1.83
Date Due: 10/29/82 - 11/13/82
Action: ☒ ACCEPT 10/11/82
☐ RETURN
☐ REJECT

Federal Agency: _____

☐ resubmission
☐ nomination by person or local government
☐ owner objection
☐ appeal

Substantive Review: ☒ sample ☐ request ☐ appeal ☐ NR decision

Reviewer's comments:

Recom./Criteria c/prior
Reviewer han Douglas
Discipline A.H.
Date 11/10/82
see continuation sheet

Nomination returned for: ☐ technical corrections cited below
☐ substantive reasons discussed below

1. Name

2. Location

3. Classification

Category	Ownership	Status	Present Use
	Public Acquisition	Accessible	

4. Owner of Property

5. Location of Legal Description

6. Representation in Existing Surveys

has this property been determined eligible? ☐ yes ☐ no

7. Description

Condition		Check one	Check one
<input type="checkbox"/> excellent	<input type="checkbox"/> deteriorated	<input type="checkbox"/> unaltered	<input type="checkbox"/> original site
<input type="checkbox"/> good	<input type="checkbox"/> ruins	<input type="checkbox"/> altered	<input type="checkbox"/> moved date _____
<input type="checkbox"/> fair	<input type="checkbox"/> unexposed		

Describe the present and original (if known) physical appearance

☒ summary paragraph
☐ completeness
☐ clarity
☐ alterations/integrity
☐ dates
☒ boundary selection NO JUSTIFICATION FOR BOUNDARY -- BUT NOT EXCESSIVE ACREAGE

8. Significance

Period _____ Areas of Significance—Check and justify below

Specific dates _____ Builder/Architect _____

Statement of Significance (in one paragraph)

- ☒ summary paragraph
- ☐ completeness
- ☐ clarity
- ☐ applicable criteria
- ☐ justification of areas checked
- ☐ relating significance to the resource
- ☐ context
- ☐ relationship of integrity to significance
- ☐ justification of exception
- ☐ other

9. Major Bibliographical References

10. Geographical Data

Acres of nominated property _____

Quadrangle name _____

USMT References

Verbal boundary description and justification

11. Form Prepared By

12. State Historic Preservation Officer Certification

The evaluated significance of this property within the state is:

☐ national ☐ state ☐ local

State Historic Preservation Officer signature

title _____ date _____

13. Other

- ☐ Maps
- ☐ Photographs
- ☐ Other

Questions concerning this nomination may be directed to _____

Signed _____ Date _____ Phone: 202 272-3504

Comments for any item may be continued on an attached sheet

Historic Resources of
Guilderland (Phase I)
Guilderland, New York
Albany County

Building #19
VEEDER FARMHOUSE #2



Detail of key design
of window lintels



Detail of ashlar stone
foundation

VEEDER FARMHOUSE #2
Historic Resources of
Guilderland (Phase I)
Building # 19



Detail of Classical
front door

Historic Resources of
Guilderland (Phase I)
Guilderland, New York
Albany County
Vaeder Farmhouse #2
Building #19



View from south showing garage

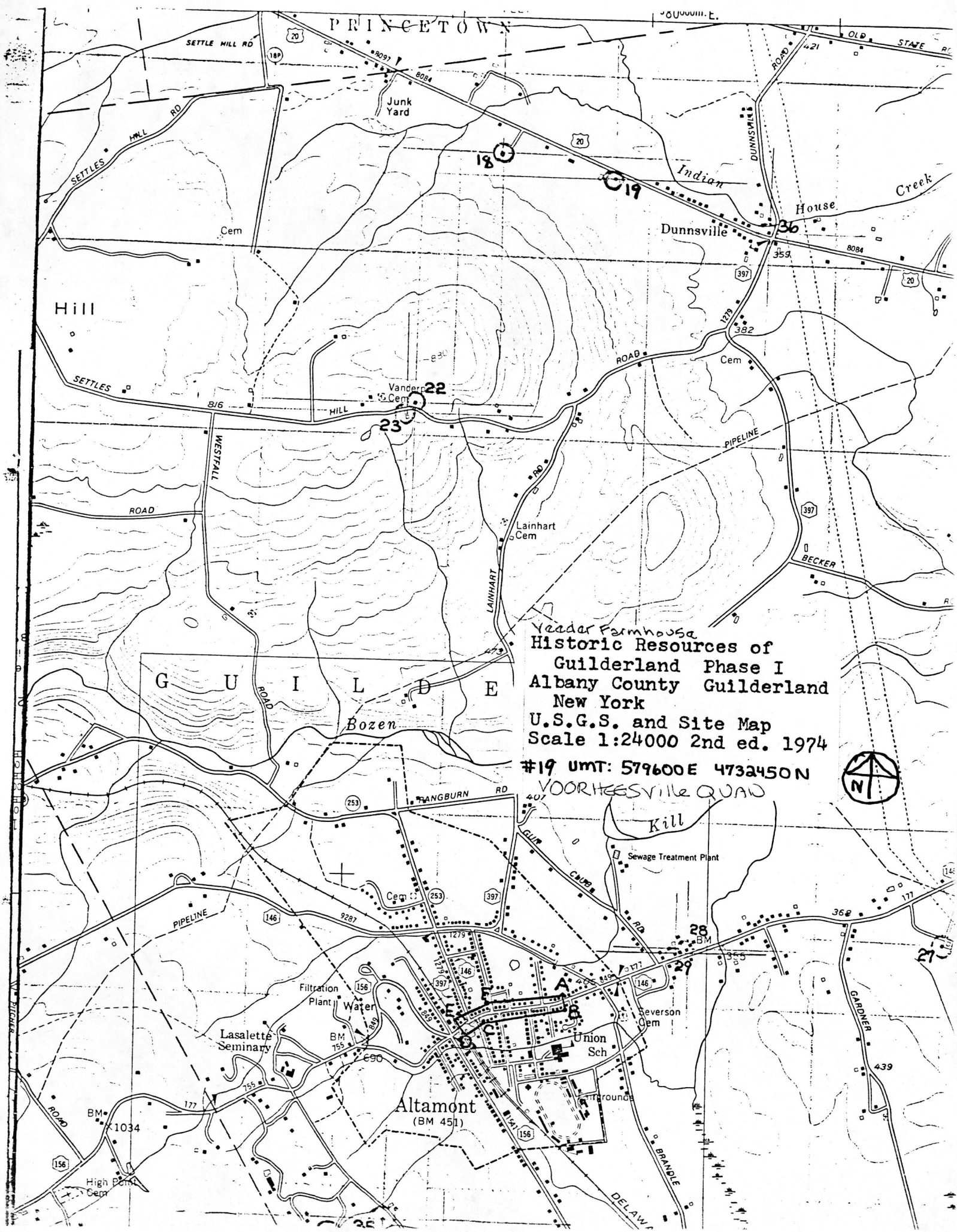

Yeadar Farmhouse
Historic Resources of
Guilderland Phase I
Albany County Guilderland
New York
U.S.G.S. and Site Map
Scale 1:24000 2nd ed. 1974

#19 UMT: 579600E 4732450N
VOORHEESVILLE QUAD

