

BUILDING-STRUCTURE INVENTORY FORM

DIVISION FOR HISTORIC PRESERVATION
NEW YORK STATE PARKS AND RECREATION
ALBANY, NEW YORK (518) 474-0479

FOR OFFICE USE ONLY

UNIQUE SITE NO. 001-06-0128
QUAD _____
SERIES _____
NEG. NO. _____

YOUR NAME: Town of Guilderland DATE: June 1, 1979

YOUR ADDRESS: Town Hall, Guilderland TELEPHONE: 518-356-1980
N.Y.

ORGANIZATION (if any): _____

***** (Gu: lderland MRA)

IDENTIFICATION

1. BUILDING NAME(S): Prospect Hill Cemetery Building (Building #12)
2. COUNTY: Albany TOWN/CITY: Guilderland VILLAGE: _____
3. STREET LOCATION: Western TPK NORTH SIDE, WEST OF RTE. 155
4. OWNERSHIP: a. public ☐ b. private ☒
5. PRESENT OWNER: Prospect Hill Cem. Asso. ADDRESS: 236 Main St., Guilderland Center, N.Y.
6. USE: Original: storage Present: storage 12085
7. ACCESSIBILITY TO PUBLIC: Exterior visible from public road: Yes ☒ No ☐
Interior accessible: Explain by appointment

DESCRIPTION

8. BUILDING MATERIAL: a. clapboard ☐ b. stone ☐ c. brick ☐ d. board and batten ☐
e. cobblestone ☒ f. shingles ☐ g. stucco ☐ other: _____
9. STRUCTURAL SYSTEM: a. wood frame with interlocking joints ☐
(if known) b. wood frame with light members ☐
c. masonry load bearing walls ☒
d. metal (explain) _____
e. other _____
10. CONDITION: a. excellent ☒ b. good ☐ c. fair ☐ d. deteriorated ☐
11. INTEGRITY: a. original site ☒ b. moved ☐ if so, when? _____
c. list major alterations and dates (if known): _____

12. PHOTO:



HP-1

13. MAP:

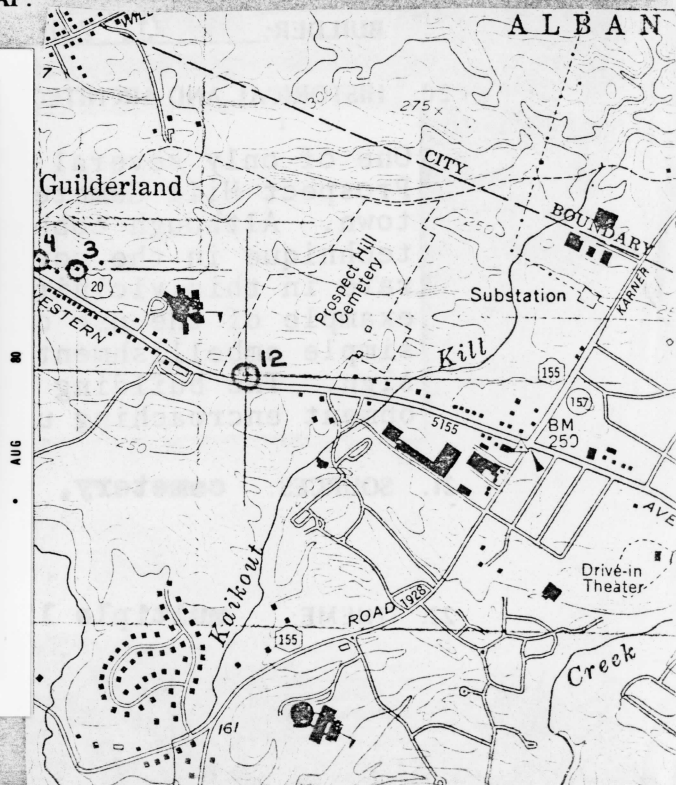

14. THREATS TO BUILDING: a. none known ☐ b. zoning ☐ c. roads ☒
d. developers ☐ e. deterioration ☐
f. other: _____

15. RELATED OUTBUILDINGS AND PROPERTY:
a. barn ☐ b. carriage house ☐ c. garage ☐
d. privy ☐ e. shed ☐ f. greenhouse ☐
g. shop ☐ h. gardens ☐
i. landscape features: _____
j. other: cemetery

16. SURROUNDINGS OF THE BUILDING (check more than one if necessary):
a. open land ☐ b. woodland ☐
c. scattered buildings ☐
d. densely built-up ☐ e. commercial ☐
f. industrial ☐ g. residential ☐
h. other: cemetery, highway

17. INTERRELATIONSHIP OF BUILDING AND SURROUNDINGS:
(Indicate if building or structure is in an historic district)
**Part of Prospect Hill Cemetery, and set into the hill
very close to heavily traveled Western Turnpike (U.S. Route 20)**

18. OTHER NOTABLE FEATURES OF BUILDING AND SITE (including interior features if known):
This small cemetery vault is constructed of coursed cobblestone with ashlar quoins; a stone lintel over the door and a quoined door surround. The gable roof is in patterned slate and has ornately sawn brackets at the overhang.

SIGNIFICANCE

19. DATE OF INITIAL CONSTRUCTION: 1863

ARCHITECT: unknown

BUILDER: J. Zeh

20. HISTORICAL AND ARCHITECTURAL IMPORTANCE:

One of only several cobblestone buildings in Guilderland, the Prospect Hill Cemetery Building is a unique structure in the town. Although cobblestone construction was a common building technique in the northeast prior to the twentieth century, it was rare in this vicinity. The vault is a significant and unusual example of the use of this material. It is well crafted, with simple embellishments typical of a straightforward vernacular design. The building survives intact amidst modern suburban development encroaching upon the area.

21. SOURCES: **cemetery, survey**

22. THEME: **multiple listings**

Prospect Hill Cemetery

Building # 12

Boundary of nominated property
is fifty feet from the walls of
the building on all sides totalling
less than one acre

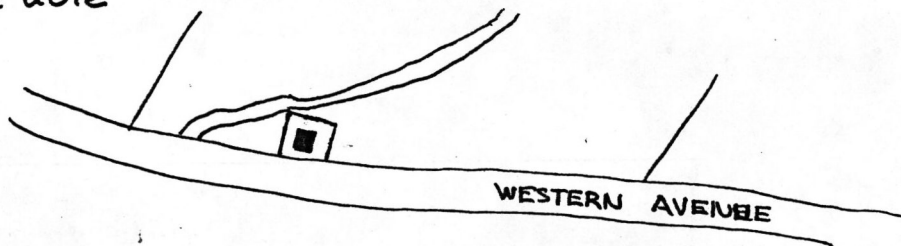

PROSPECT HILL CEMETERY BUILDING

Historic Resources of
Guilderland Phase I
Albany County Guilderland
New York
Site Map (from tax map)
Smith & Mahoney 1979

1"=400'

N ↑

United States Department of the Interior
National Park ServiceNational Register of Historic Places
Inventory—Nomination Form

OMB NO. 1024-0018

EXP. 12/31/84

For NPS use only

received

date entered

Continuation sheet

Item number

Page 3 of 4

Multiple Resource Area
Thematic GroupName Guilderland Multiple Resource Area
State New York

Nomination/Type of Review

Date/Signature

21. St. Mark's Lutheran Church

Entered in the
National Register

for Keeper

Attest

Delores Byers 11/10/8222. Prospect Hill Cemetery
BuildingEntered in the
National Register

for Keeper

Attest

Delores Byers 11/10/82

23. Fuller's Tavern

Entered in the
National Register

for Keeper

Attest

Delores Byers 11/10/82

24. Veeder Farmhouse #1

Entered in the
National Register

for Keeper

Attest

Delores Byers 11/10/82

25. Veeder Farmhouse #2

Substantive Review

Keeper

Attest

Bruce Van Duzee 11/10/82

26. Van Patten Barn Complex

Entered in the
National Register

for Keeper

Attest

Delores Byers 11/10/82

27. Gillespie House

Entered in the
National Register

for Keeper

Attest

Delores Byers 11/10/82

28. Sharp Brothers House

Entered in the
National Register

for Keeper

Attest

Delores Byers 11/10/82

29. Sharp Farmhouse

Entered in the
National Register

for Keeper

Attest

Delores Byers 11/10/82

30. Parker, Charles, House

Substantive Review

Keeper

Attest

Bruce Van Duzee 11/10/82

United States Department of the Interior
National Park Service

Prospect Hill Cemetery Building (Guilderland MRA)
Albany County
NEW YORK

Working No. 9/29/82-2482

Fed. Reg. Date: 2.1.83

Date Due: 10/29/82 - 11/13/82

Action: ☒ ACCEPT 11/10/82

☐ RETURN

Entered in the ☐ REJECT

National Register

Federal Agency: _____

- ☐ resubmission
☐ nomination by person or local government
☐ owner objection
☐ appeal

Substantive Review: ☐ sample ☐ request ☐ appeal ☐ NR decision

Reviewer's comments: _____

Recom./Criteria _____

Reviewer _____

Discipline _____

Date _____

see continuation sheet

Nomination returned for: ☐ technical corrections cited below
☐ substantive reasons discussed below

1. Name

2. Location

3. Classification

Category	Ownership	Status	Present Use
	Public Acquisition	Accessible	

4. Owner of Property

5. Location of Legal Description

6. Representation in Existing Surveys

has this property been determined eligible? ☐ yes ☐ no

7. Description

Condition		Check one	Check one
<input type="checkbox"/> excellent	<input type="checkbox"/> deteriorated	<input type="checkbox"/> unaltered	<input type="checkbox"/> original site
<input type="checkbox"/> good	<input type="checkbox"/> ruins	<input type="checkbox"/> altered	<input type="checkbox"/> moved date _____
<input type="checkbox"/> fair	<input type="checkbox"/> unexposed		

Describe the present and original (if known) physical appearance

- ☐ summary paragraph
☐ completeness
☐ clarity
☐ alterations/integrity
☐ dates
☐ boundary selection

8. Significance

Period _____ Areas of Significance—Check and justify below

Specific dates _____ Builder/Architect _____

Statement of Significance (in one paragraph)

- _____ summary paragraph
- _____ completeness
- _____ clarity
- _____ applicable criteria
- _____ justification of areas checked
- _____ relating significance to the resource
- _____ context
- _____ relationship of integrity to significance
- _____ justification of exception
- _____ other

9. Major Bibliographical References

10. Geographical Data

Acreage of nominated property _____

Quadrangle name _____

USMT References

Verbal boundary description and justification

11. Form Prepared By

12. State Historic Preservation Officer Certification

The evaluated significance of this property within the state is:

_____ national _____ state _____ local

State Historic Preservation Officer signature

Title _____ date _____

13. Other

- _____ Maps
- _____ Photographs
- _____ Other

Questions concerning this nomination may be directed to _____

Signed _____ Date _____ Phone: 202 272-3504

Comments for any item may be continued on an attached sheet

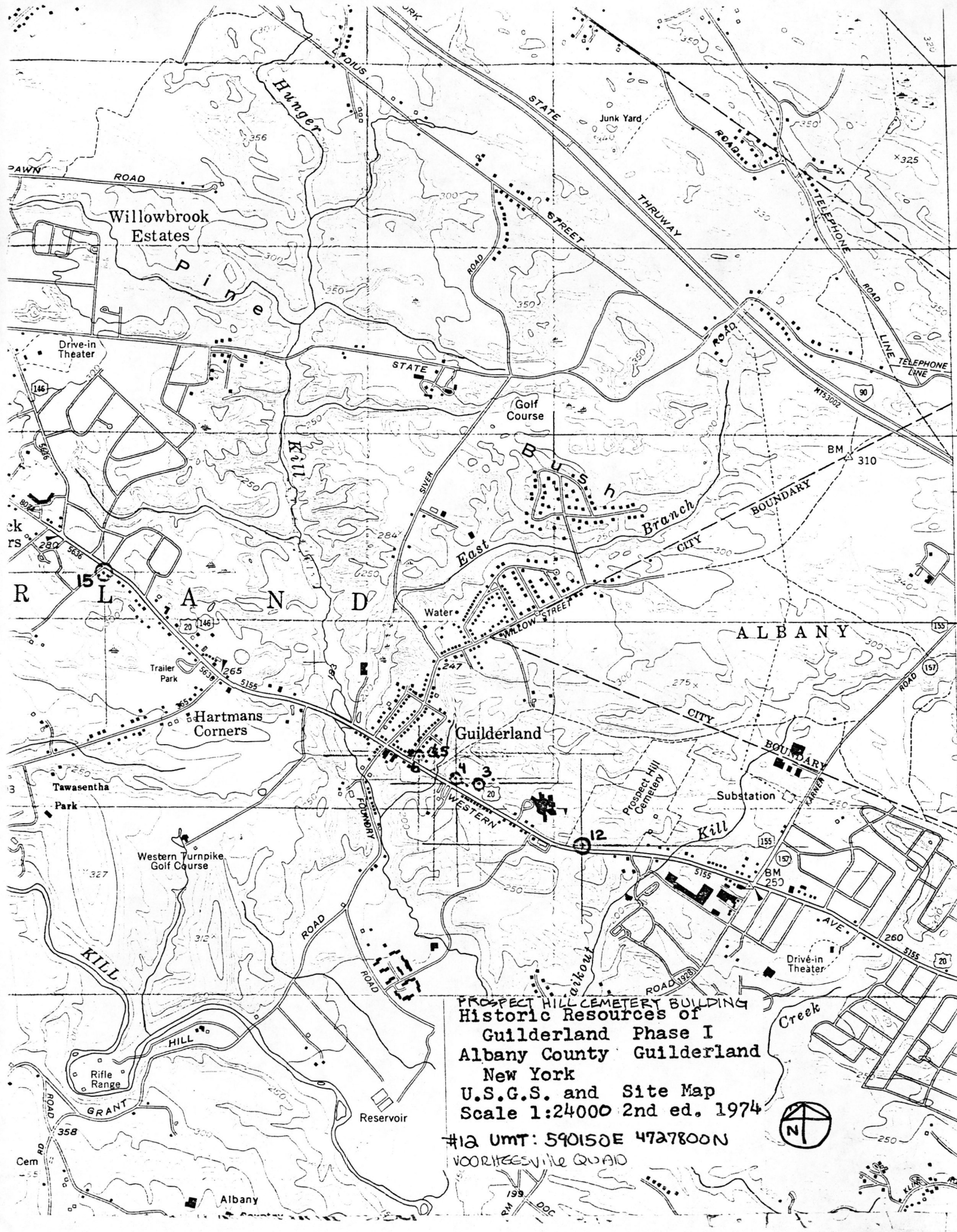

PROSPECT HILL CEMETERY BUILDING
Historic Resources of
Guilderland Phase I
Albany County Guilderland
New York
U.S.G.S. and Site Map
Scale 1:24000 2nd ed. 1974

#12 UMT: 590150E 4727800N
VOORHEESVILLE QUAD

