

BUILDING-STRUCTURE INVENTORY FORM

DIVISION FOR HISTORIC PRESERVATION
NEW YORK STATE PARKS AND RECREATION
ALBANY, NEW YORK (518) 474-0479

FOR OFFICE USE ONLY

UNIQUE SITE NO. 001-06-0124
QUAD _____
SERIES _____
NEG. NO. _____

YOUR NAME: Town of Guilderland DATE: June 1, 1979

YOUR ADDRESS: Town Hall, Guilderland TELEPHONE: _____
N.Y.

ORGANIZATION (if any): _____

IDENTIFICATION (Guilderland MRA)

1. BUILDING NAME(S): Hamilton Union Presbyterian Church (Building #5)
2. COUNTY Albany TOWN/CITY Guilderland VILLAGE: _____
3. STREET LOCATION: 2291 Western Tr
4. OWNERSHIP: a. public ☐ b. private ☒
5. PRESENT OWNER: Trustees, H.U.P.C. ADDRESS: Box 151 Guilderland, N.Y. 12084
6. USE: Original: church Present: church
7. ACCESSIBILITY TO PUBLIC: Exterior visible from public road: Yes ☒ No ☐
Interior accessible: Explain Sundays and by appointment

DESCRIPTION

8. BUILDING MATERIAL: a. clapboard ☒ b. stone ☐ c. brick ☐ d. board and batten ☐
e. cobblestone ☐ f. shingles ☐ g. stucco ☐ other: _____
9. STRUCTURAL SYSTEM: a. wood frame with interlocking joints ☐
(if known) b. wood frame with light members ☒
c. masonry load bearing walls ☐
d. metal (explain) _____
e. other buttresses on side walls
10. CONDITION: a. excellent ☒ b. good ☐ c. fair ☐ d. deteriorated ☐
11. INTEGRITY: a. original site ☒ b. moved ☐ if so, when? _____
c. list major alterations and dates (if known):
1972 - interior partition removed and structural tie-rods installed
1963 - education annex constructed

12. PHOTO:

13. MAP:

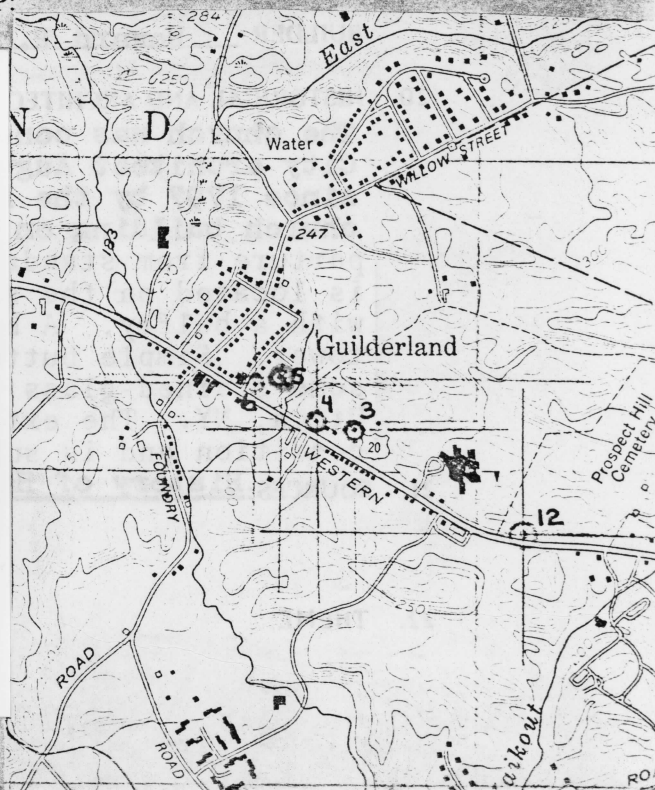

14. THREATS TO BUILDING: a. none known ☒ b. zoning ☐ c. roads ☐
d. developers ☐ e. deterioration ☐
f. other: _____
15. RELATED OUTBUILDINGS AND PROPERTY:
a. barn ☐ b. carriage house ☐ c. garage ☐
d. privy ☐ e. shed ☐ f. greenhouse ☐
g. shop ☐ h. gardens ☐
i. landscape features: parking lot on south side
j. other: educational annex 1963 (not historic)
16. SURROUNDINGS OF THE BUILDING (check more than one if necessary):
a. open land ☐ b. woodland ☐
c. scattered buildings ☒
d. densely built-up ☐ e. commercial ☐
f. industrial ☐ g. residential ☒
h. other: _____

17. INTERRELATIONSHIP OF BUILDING AND SURROUNDINGS:

(Indicate if building or structure is in an historic district)

The church is set back from Western Avenue and is located in a residential area.

18. OTHER NOTABLE FEATURES OF BUILDING AND SITE (including interior features if known):

The Stick Style church has a large open bell tower on the south side. The building has an unusual structural design that incorporates buttresses to compensate for the lack of roof trusses. The interior retains the original pews and red pine woodwork.

SIGNIFICANCE

19. DATE OF INITIAL CONSTRUCTION: 1886

ARCHITECT: August Howe

BUILDER: Howard P. Foster & Martin Talmage

20. HISTORICAL AND ARCHITECTURAL IMPORTANCE:

The church was constructed in 1886 and designed by New York City architect August Howe. The church has been supported since 1797 by the hamlet of Hamiltonville and is the third church building on this site. The church is unusual in its departure from standard ecclesiastical design. The main entrance is located on the side of the nave beneath a Stick style tower with a belfry. A bracketed cornice surrounds the building and tower. Simple buttresses punctuate the side walls. The handsome stained-glass windows were crafted by Charles P. Davis of Utica, NY. The exterior of the original structure is in excellent condition and is substantially intact. The church is historically

21. SOURCES: History of Hamilton Union Church: W. & M. Embler, 1974

22. THEME:

Historic Resources of Guilderland (Phase I)
Guilderland, NY
Albany County
Hamilton Union Presbyterian Church (Building #5)

continuation sheet

20. and architecturally significant as the social and visual focus of Hamilton-
ville.

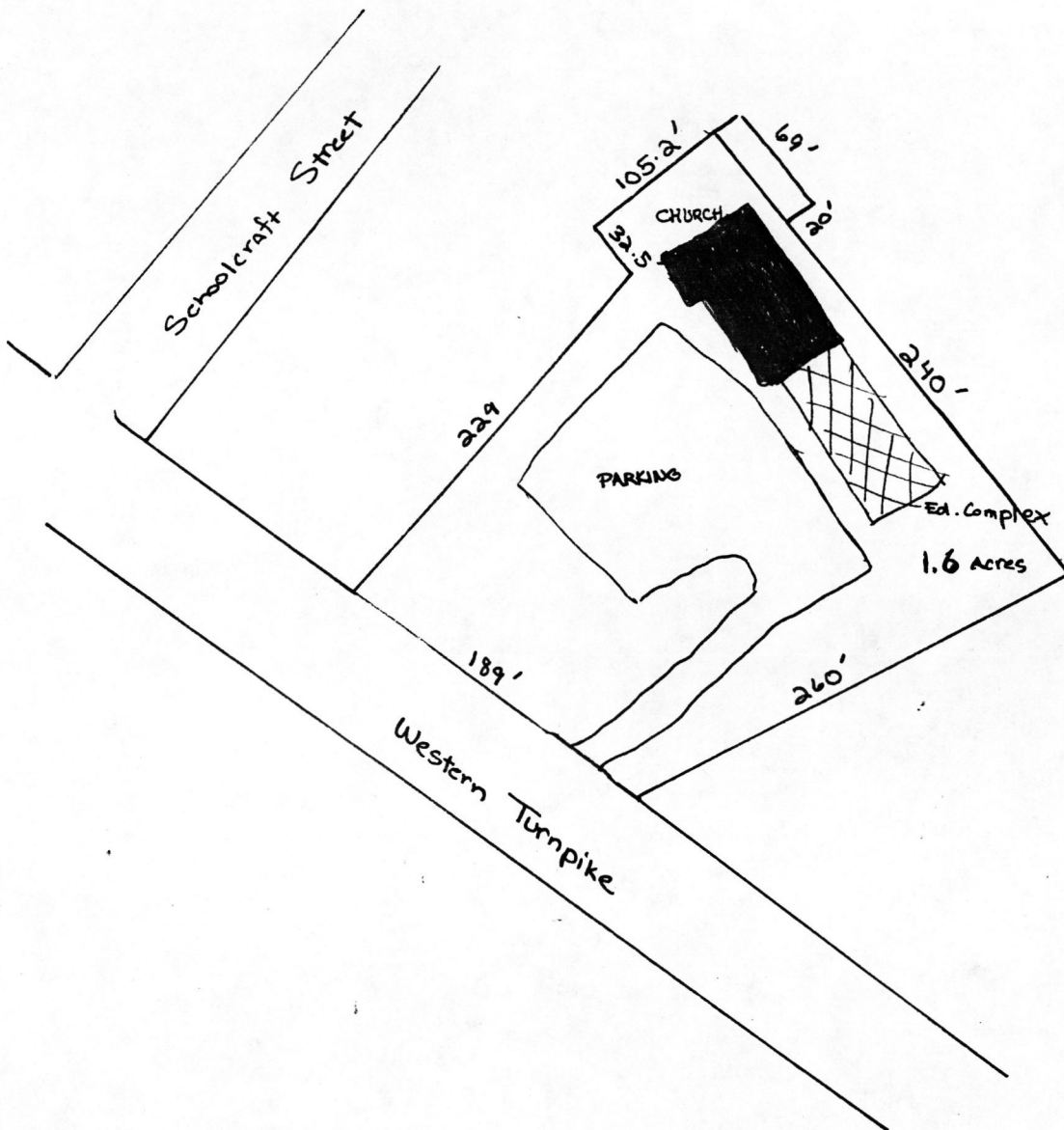

1"=100'

Historic Resources of
Guilderland Phase I
Albany County Guilderland
New York
Site Map (from tax map)
Smith & Mahoney 1979

United States Department of the Interior
National Park ServiceNational Register of Historic Places
Inventory—Nomination Form

For NPS use only

received

date entered

Continuation sheet

Item number

Page 2 of 4

Multiple Resource Area
Thematic GroupName Guilderland Multiple Resource AreaState New York

Nomination/Type of Review

Date/Signature

11. Aumic House

Entered in the
National Register

for Keeper

Delores Byers 11/10/82

Attest

12. Coppola House

Entered in the
National Register

for Keeper

Delores Byers 11/10/82

Attest

13. Schoolcraft, John, House

Entered in the
National Register

for Keeper

Delores Byers 11/10/82

Attest

14. Helderberg Reformed Dutch
ChurchEntered in the
National Register

for Keeper

Delores Byers 11/10/82

Attest

15. Mynderse-Frederick House

Substantive Review

Keeper

James Lee Douglass 11/10/82

Attest

16. Chapel House

Entered in the
National Register

for Keeper

Delores Byers 11/10/82

Attest

17. Rose Hill

Entered in the
National Register

for Keeper

Delores Byers 11/10/82

Attest

18. Hamilton Union Church
RectoryEntered in the
National Register

for Keeper

Delores Byers 11/10/82

Attest

19. Hamilton Union Presbyterian
ChurchEntered in the
National Register

for Keeper

Delores Byers 11/10/82

Attest

20. Schoolhouse #6

Substantive Review

Keeper

James Lee Douglass 11/10/82

Attest

United States Department of the Interior
National Park Service

Hamilton Union Presbyterian Church (Guilderland
MRA)
Albany County
NEW YORK

Working No. 9/29/82-2682
Fed. Reg. Date: 2.1.83
Date Due: 8/29/82 - 11/13/82
Action: ☒ ACCEPT 11/10/82
☐ RETURN
☐ REJECT
Federal Agency: _____

☐ resubmission
☐ nomination by person or local government
☐ owner objection
☐ appeal

Entered in the
Register

Substantive Review: ☐ sample ☐ request ☐ appeal ☐ NR decision

Reviewer's comments:

Recom./Criteria _____
Reviewer _____
Discipline _____
Date _____
see continuation sheet

Nomination returned for: ☐ technical corrections cited below
☐ substantive reasons discussed below

1. Name

2. Location

3. Classification

Category	Ownership	Status	Present Use
	Public Acquisition	Accessible	

4. Owner of Property

5. Location of Legal Description

6. Representation in Existing Surveys

has this property been determined eligible? ☐ yes ☐ no

7. Description

Condition		Check one	Check one
<input type="checkbox"/> excellent	<input type="checkbox"/> deteriorated	<input type="checkbox"/> unaltered	<input type="checkbox"/> original site
<input type="checkbox"/> good	<input type="checkbox"/> ruins	<input type="checkbox"/> altered	<input type="checkbox"/> moved date _____
<input type="checkbox"/> fair	<input type="checkbox"/> unexposed		

Describe the present and original (if known) physical appearance

☐ summary paragraph
☐ completeness
☐ clarity
☐ alterations/integrity
☐ dates
☐ boundary selection

8. Significance

Period _____ Areas of Significance—Check and justify below

Specific dates _____ Builder/Architect _____

Statement of Significance (in one paragraph)

- ☐ summary paragraph
- ☐ completeness
- ☐ clarity
- ☐ applicable criteria
- ☐ justification of areas checked
- ☐ relating significance to the resource
- ☐ context
- ☐ relationship of integrity to significance
- ☐ justification of exception
- ☐ other

9. Major Bibliographical References

10. Geographical Data

Acreage of nominated property _____

Quadrangle name _____

USGS References

Verbal boundary description and justification

11. Form Prepared By

12. State Historic Preservation Officer Certification

The evaluated significance of this property within the state is:

☐ national ☐ state ☐ local

State Historic Preservation Officer signature

Title _____ date _____

13. Other

- ☐ Maps
- ☐ Photographs
- ☐ Other

Questions concerning this nomination may be directed to _____

Signed _____ Date _____ Phone: 202 272-3504

Comments for any item may be continued on an attached sheet



Historic Resources of
 Guilderland (Phase I)
 Guilderland, New York
 Albany County
 Building #5
 HAMILTON UNION PRESBYTERIAN
 CHURCH
 Detail of open belfry

Detail of carved
 detailing

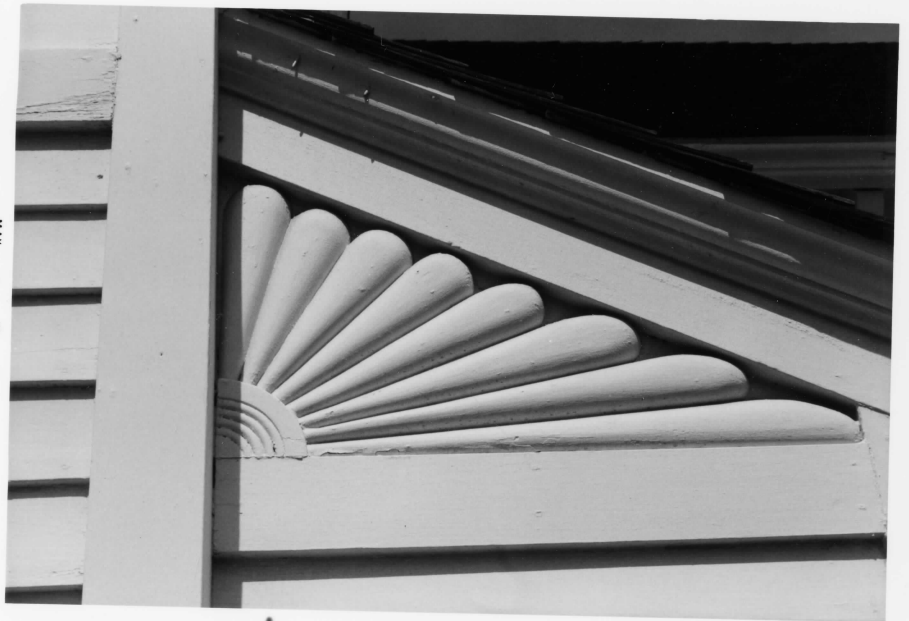

HAMILTON UNION PRESBYTERIAN
CHURCH
Historic Resources of
Guilderland (Phase I)
Guilderland, New York
Albany County
Building #5



Non-contributing addition



Historic Resources of
Guilderland Phase I
Albany County Guilderland
New York
U.S.G.S. and Site Map
Scale 1:24000 2nd ed. 1974
VOORHEESVILLE QUAD
#5 UTM: 589370E 4728300N
HAMILTON UNION PRESBY-
TERIAN CHURCH