

# BUILDING-STRUCTURE INVENTORY FORM

DIVISION FOR HISTORIC PRESERVATION  
NEW YORK STATE PARKS AND RECREATION  
ALBANY, NEW YORK (518) 474-0479

FOR OFFICE USE ONLY

UNIQUE SITE NO. 001-06-0038  
QUAD \_\_\_\_\_  
SERIES \_\_\_\_\_  
NEG. NO. \_\_\_\_\_

YOUR NAME: Town of Guilderland DATE: June 1, 1979

YOUR ADDRESS: Town Hall, Guilderland TELEPHONE: 518-356-1980  
N.Y.

ORGANIZATION (if any): \_\_\_\_\_

\*\*\*\*\* (Guilderland MRA) \*\*\*\*\*

## IDENTIFICATION

1. BUILDING NAME(S): Fuller's Tavern (Building #13)
2. COUNTY: Albany TOWN: Guilderland CITY: Guilderland VILLAGE: \_\_\_\_\_
3. STREET LOCATION: 6861 Western Tpk
4. OWNERSHIP: a. public ☐ b. private ☒
5. PRESENT OWNER: Jock A. Farnsworth ADDRESS: 6861 Western Tpke. R.D. 2, Altamont, N.Y. 12009
6. USE: Original: Tavern & Hotel Present: Residence
7. ACCESSIBILITY TO PUBLIC: Exterior visible from public road: Yes ☒ No ☐  
Interior accessible: Explain by appointment

## DESCRIPTION

8. BUILDING MATERIAL: a. clapboard ☒ b. stone ☐ c. brick ☐ d. board and batten ☐  
e. cobblestone ☐ f. shingles ☐ g. stucco ☐ other: \_\_\_\_\_
9. STRUCTURAL SYSTEM: a. wood frame with interlocking joints ☒  
(if known) b. wood frame with light members ☐  
c. masonry load bearing walls ☐  
d. metal (explain) \_\_\_\_\_  
e. other \_\_\_\_\_
10. CONDITION: a. excellent ☒ b. good ☐ c. fair ☐ d. deteriorated ☐
11. INTEGRITY: a. original site ☒ b. moved ☐ if so, when? \_\_\_\_\_  
c. list major alterations and dates (if known): \_\_\_\_\_

12. PHOTO:



13. MAP:

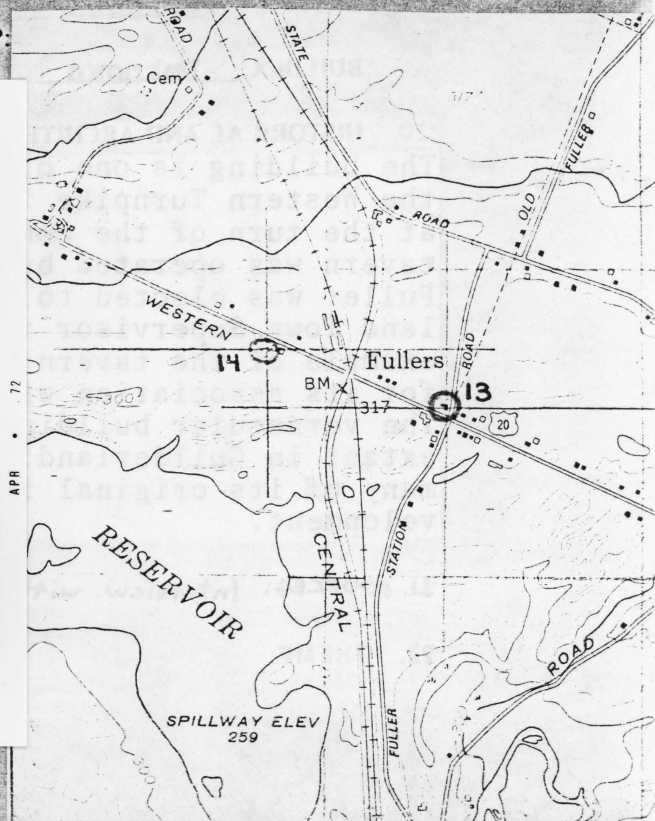



14. THREATS TO BUILDING: a. none known ☒ b. zoning ☐ c. roads ☐  
 d. developers ☐ e. deterioration ☐  
 f. other: \_\_\_\_\_
15. RELATED OUTBUILDINGS AND PROPERTY:  
 a. barn ☒ b. carriage house ☐ c. garage ☐  
 d. privy ☐ e. shed ☐ f. greenhouse ☐  
 g. shop ☐ h. gardens ☐  
 i. landscape features: \_\_\_\_\_  
 j. other: Wagon shed
16. SURROUNDINGS OF THE BUILDING (check more than one if necessary):  
 a. open land ☒ b. woodland ☐  
 c. scattered buildings ☒  
 d. densely built-up ☐ e. commercial ☐  
 f. industrial ☐ g. residential ☒  
 h. other: \_\_\_\_\_

17. INTERRELATIONSHIP OF BUILDING AND SURROUNDINGS:  
 (Indicate if building or structure is in an historic district)  
**Located very close to Western Turnpike and the railroad bridge that crosses the road.**

18. OTHER NOTABLE FEATURES OF BUILDING AND SITE (including interior features if known):  
**Two-story wood frame house with "salt box" roof; stone foundation; carriage barn attached to the west; interior retains many of the original features such as wainscoating, large fireplace and staircase.**

**SIGNIFICANCE**

19. DATE OF INITIAL CONSTRUCTION: ca. 1795

ARCHITECT: Unknown

BUILDER: Unknown

**20. HISTORICAL AND ARCHITECTURAL IMPORTANCE:**

The building is one of the few remaining inns of those built along the Western Turnpike in the late eighteenth century. Constructed at the turn of the century, it opened as a tavern in 1806. The tavern was operated by Hon. John Fuller, a major in the State Militia. Fuller was elected to the State Legislature in 1846 and was Guilderland Town Supervisor from 1846-1848. The building is a significant example of the tavern houses of the period and important locally for its association with the Fuller family. The vernacular building is one of the earliest structures still extant in Guilderland. It survives, largely intact and retaining many of its original interior features, amidst modern suburban development.

21. SOURCES: Interview with owner; see bibliography

22. THEME:

6861 Western Turnpike

Building # 13

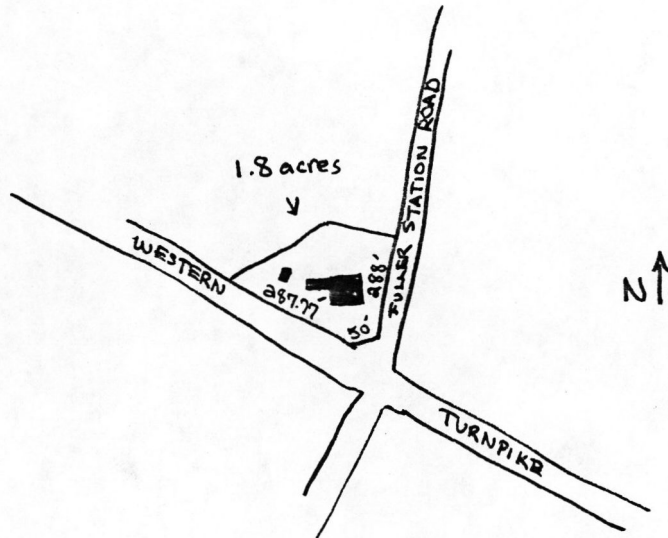

1"=400'

FULLER'S TAVERN

Historic Resources of  
Guilderland Phase I  
Albany County Guilderland  
New York

Site Map (from tax map)  
Smith & Mahoney 1979



United States Department of the Interior  
National Park ServiceNational Register of Historic Places  
Inventory—Nomination Form

OMB NO. 1024-0018

EXP. 12/31/84

For NPS use only

received

date entered

Continuation sheet

Item number

Page 3 of 4

Multiple Resource Area  
Thematic GroupName Guilderland Multiple Resource Area  
State New York

Nomination/Type of Review

Date/Signature

21. St. Mark's Lutheran Church

Entered in the  
National Register

for Keeper

Attest

Delores Byers 11/10/8222. Prospect Hill Cemetery  
BuildingEntered in the  
National Register

for Keeper

Attest

Delores Byers 11/10/82

23. Fuller's Tavern

Entered in the  
National Register

for Keeper

Attest

Delores Byers 11/10/82

24. Veeder Farmhouse #1

Entered in the  
National Register

for Keeper

Attest

Delores Byers 11/10/82

25. Veeder Farmhouse #2

Substantive Review

Keeper

Attest

Anna Lee Dwyer 11/10/82

26. Van Patten Barn Complex

Entered in the  
National Register

for Keeper

Attest

Delores Byers 11/10/82

27. Gillespie House

Entered in the  
National Register

for Keeper

Attest

Delores Byers 11/10/82

28. Sharp Brothers House

Entered in the  
National Register

for Keeper

Attest

Delores Byers 11/10/82

29. Sharp Farmhouse

Entered in the  
National Register

for Keeper

Attest

Delores Byers 11/10/82

30. Parker, Charles, House

Substantive Review

Keeper

Attest

Anna Lee Dwyer 11/10/82



United States Department of the Interior  
National Park Service

Fuller's Tavern (Guilderland MRA)  
Albany County  
NEW YORK

Working No. 969/82-2682

Fed. Reg. Date: 2.1.83

Date Due: 10/29/82 - 11/13/82

Action: ☒ ACCEPT 11/10/82

☐ RETURN

☐ REJECT

Entered in the  
National Register

Federal Agency: \_\_\_\_\_

- ☐ resubmission  
☐ nomination by person or local government  
☐ owner objection  
☐ appeal

Substantive Review: ☐ sample ☐ request ☐ appeal ☐ NR decision

Reviewer's comments:

Recom./Criteria \_\_\_\_\_

Reviewer \_\_\_\_\_

Discipline \_\_\_\_\_

Date \_\_\_\_\_

☐ see continuation sheet

Nomination returned for: ☐ technical corrections cited below  
☐ substantive reasons discussed below

1. Name

2. Location

3. Classification

Category	Ownership	Status	Present Use
	Public Acquisition	Accessible	

4. Owner of Property

5. Location of Legal Description

6. Representation in Existing Surveys

has this property been determined eligible? ☐ yes ☐ no

7. Description

Condition	Check one	Check one
<input type="checkbox"/> excellent	<input type="checkbox"/> deteriorated	<input type="checkbox"/> unaltered
<input type="checkbox"/> good	<input type="checkbox"/> ruins	<input type="checkbox"/> altered
<input type="checkbox"/> fair	<input type="checkbox"/> unexposed	<input type="checkbox"/> moved date _____

Describe the present and original (if known) physical appearance

- ☐ summary paragraph  
☐ completeness  
☐ clarity  
☐ alterations/integrity  
☐ dates  
☐ boundary selection

## **8. Significance**

Period \_\_\_\_\_ Areas of Significance—Check and justify below

Specific dates \_\_\_\_\_ Builder/Architect \_\_\_\_\_

Statement of Significance (in one paragraph)

- ☐ summary paragraph
- ☐ completeness
- ☐ clarity
- ☐ applicable criteria
- ☐ justification of areas checked
- ☐ relating significance to the resource
- ☐ context
- ☐ relationship of integrity to significance
- ☐ justification of exception
- ☐ other

## **9. Major Bibliographical References**

## **10. Geographical Data**

Acres of nominated property \_\_\_\_\_  
Quadrangle name \_\_\_\_\_  
UNIT References \_\_\_\_\_

Verbal boundary description and justification \_\_\_\_\_

## **11. Form Prepared By**

## **12. State Historic Preservation Officer Certification**

The evaluated significance of this property within the state is:  
\_\_\_\_\_ national \_\_\_\_\_ state \_\_\_\_\_ local

State Historic Preservation Officer signature \_\_\_\_\_

Title \_\_\_\_\_ date \_\_\_\_\_

## **13. Other**

- ☐ Maps
- ☐ Photographs
- ☐ Other

Questions concerning this nomination may be directed to \_\_\_\_\_

Signed \_\_\_\_\_ Date \_\_\_\_\_ Phone: 202 272-3504

Comments for any item may be continued on an attached sheet



FULLER'S TAVERN  
Historic Resources of  
Guilderland (Phase I)  
Guilderland, New York  
Albany County  
Building #13

Eastern elevation



MAY • 80 •

Carriage shed, southern elevation



MAY • 80 •

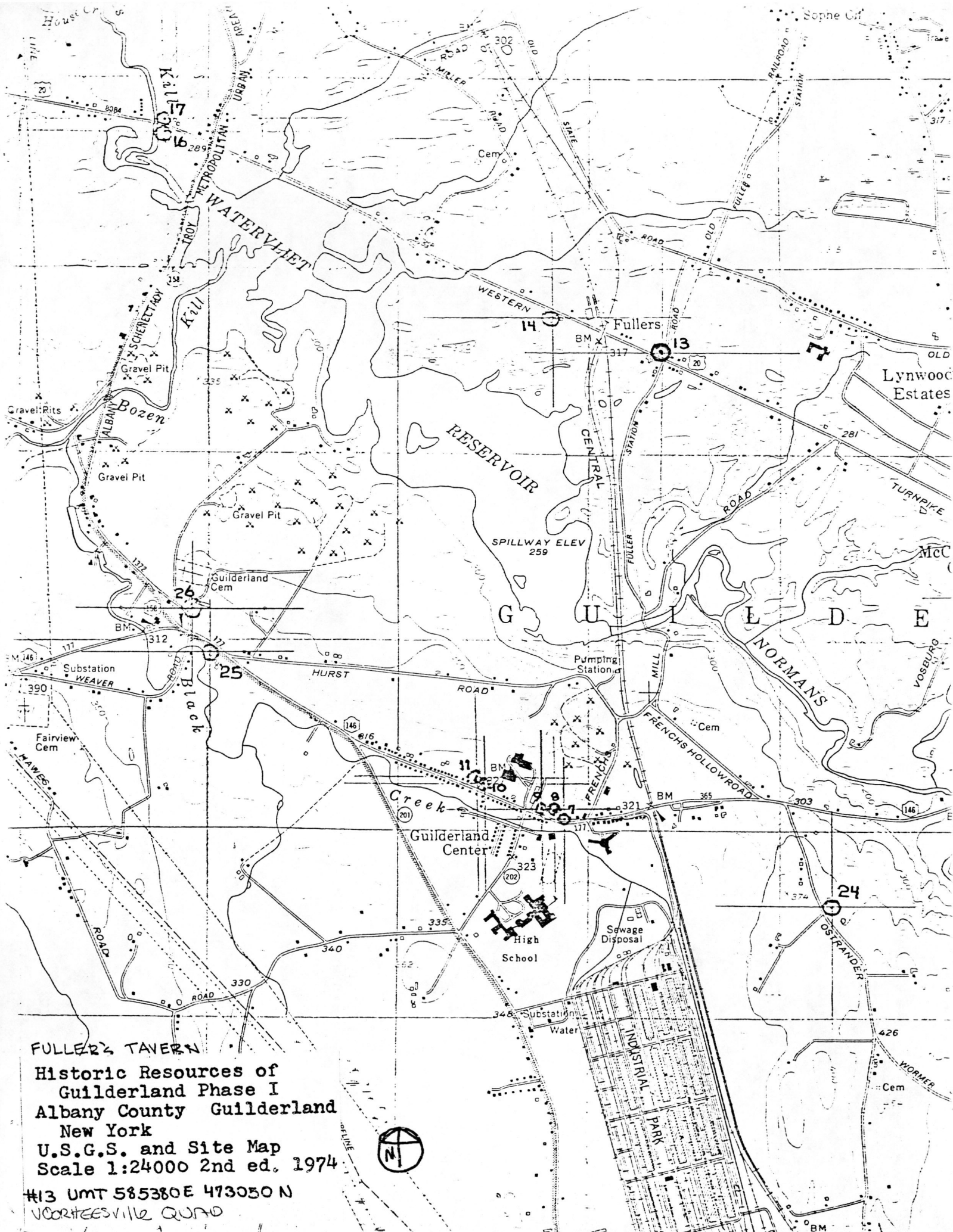

FULLER'S TAVERN

Historic Resources of  
Guilderland Phase I  
Albany County Guilderland  
New York

U.S.G.S. and Site Map  
Scale 1:24000 2nd ed. 1974

#13 UMT 585380E 473050N  
VOORHEESVILLE QUAD