

BUILDING-STRUCTURE INVENTORY FORM

DIVISION FOR HISTORIC PRESERVATION
NEW YORK STATE PARKS AND RECREATION
ALBANY, NEW YORK (518) 474-0479

FOR OFFICE USE ONLY

UNIQUE SITE NO 001-06-0142
QUAD _____
SERIES _____
NEG. NO. _____

YOUR NAME: Town of Guilderland DATE: June 1, 1979

YOUR ADDRESS: Town Hall, Guilderland, N.Y. TELEPHONE: 518-356-1980

ORGANIZATION (if any): _____

IDENTIFICATION

1. BUILDING NAME(S): Coppola Residence (Building # 34)
2. COUNTY: Albany TOWN/CITY: Guilderland VILLAGE: _____
3. STREET LOCATION: Leesome Ln; West Side; ON PRIVATE RD.
4. OWNERSHIP: a. public ☐ b. private ☒
5. PRESENT OWNER: V. Coppola ADDRESS: Leesome Lane, Altamont, N.Y. 12009
6. USE: Original: summer residence Present: residence
7. ACCESSIBILITY TO PUBLIC: Exterior visible from public road: Yes ☒ No ☐
Interior accessible: Explain by appointment

DESCRIPTION

8. BUILDING MATERIAL: a. clapboard ☒ b. stone ☐ c. brick ☐ d. board and batten ☐
e. cobblestone ☐ f. shingles ☐ g. stucco ☐ other: _____
9. STRUCTURAL SYSTEM: a. wood frame with interlocking joints ☐
(if known) b. wood frame with light members ☒
c. masonry load bearing walls ☐
d. metal (explain) _____
e. other _____
10. CONDITION: a. excellent ☐ b. good ☒ c. fair ☐ d. deteriorated ☐
11. INTEGRITY: a. original site ☒ b. moved ☐ if so, when? _____
c. list major alterations and dates (if known): _____

12. PHOTO:

13. MAP:

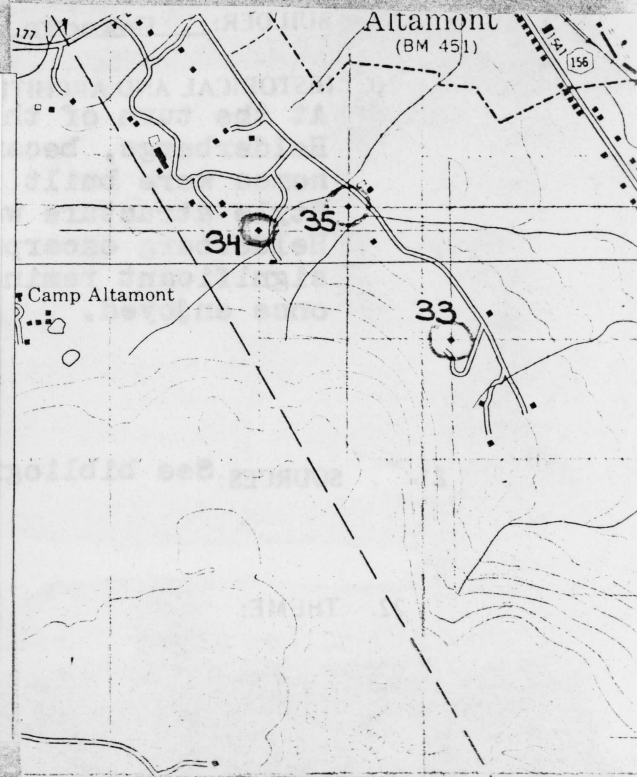

14. THREATS TO BUILDING: a. none known ☒ b. zoning ☐ c. roads ☐
 d. developers ☐ e. deterioration ☐
 f. other: _____
15. RELATED OUTBUILDINGS AND PROPERTY:
 a. barn ☐ b. carriage house ☐ c. garage ☒ (Not Historic - modern)
 d. privy ☐ e. shed ☐ f. greenhouse ☐
 g. shop ☐ h. gardens ☐
 i. landscape features: _____
 j. other: _____
16. SURROUNDINGS OF THE BUILDING (check more than one if necessary):
 a. open land ☒ b. woodland ☒
 c. scattered buildings ☒
 d. densely built-up ☐ e. commercial ☐
 f. industrial ☐ g. residential ☒
 h. other: _____

17. INTERRELATIONSHIP OF BUILDING AND SURROUNDINGS:

(Indicate if building or structure is in an historic district)

The house is located half way up the side of the Helderberg escarpment and has a commanding view of Altamont and the lands east.

18. OTHER NOTABLE FEATURES OF BUILDING AND SITE (including interior features if known):

Excellent Colonial Revival Style three-story home; gambrel roof with gables and dormers, massive paneled chimneys; dentiled cornice; Palladian window; one-story porch surrounding with porte-co chere. The interior retains much of the original classical detail.

SIGNIFICANCE

19. DATE OF INITIAL CONSTRUCTION: ca. 1910

ARCHITECT: Unknown

BUILDER: Unknown

20. HISTORICAL AND ARCHITECTURAL IMPORTANCE:

At the turn of the century, Altamont, at the base of the Helderbergs, became a popular summer retreat and many fine summer homes were built in the area. This outstanding Colonial Revival Style structure was built as a summer home on the side of the Helderberg escarpment. The house remains unaltered and is a significant reminder of the lifestyle and wealth that Altamont once enjoyed.

21. SOURCES: See bibliography

22. THEME:

Leesome Lane

Building # 34

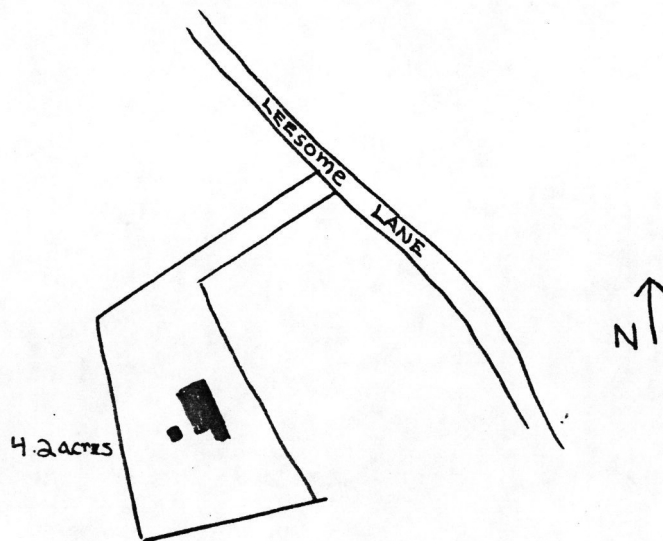

Historic Resources of
Guilderland Phase I
Albany County Guilderland
New York
Site Map (from tax map)
Smith & Mahoney 1979
Coppola Residence

1" = 400'

United States Department of the Interior
National Park ServiceNational Register of Historic Places
Inventory—Nomination Form

For NPS use only

received

date entered

Continuation sheet

Item number

Page 2 of 4

Multiple Resource Area
Thematic GroupName Guilderland Multiple Resource AreaState New York

Nomination/Type of Review

Date/Signature

11. Aumic House

Entered in the
National Register

for Keeper

Delores Byers 11/10/82

Attest

12. Coppola House

Entered in the
National Register

for Keeper

Delores Byers 11/10/82

Attest

13. Schoolcraft, John, House

Entered in the
National Register

for Keeper

Delores Byers 11/10/82

Attest

14. Helderberg Reformed Dutch
ChurchEntered in the
National Register

for Keeper

Delores Byers 11/10/82

Attest

15. Mynderse-Frederick House

Substantive Review

Keeper

Bruce Van Donge 11/10/82

Attest

16. Chapel House

Entered in the
National Register

for Keeper

Delores Byers 11/10/82

Attest

17. Rose Hill

Entered in the
National Register

for Keeper

Delores Byers 11/10/82

Attest

18. Hamilton Union Church
RectoryEntered in the
National Register

for Keeper

Delores Byers 11/10/82

Attest

19. Hamilton Union Presbyterian
ChurchEntered in the
National Register

for Keeper

Delores Byers 11/10/82

Attest

20. Schoolhouse #6

Substantive Review

Keeper

Bruce Van Donge 11/10/82

Attest

United States Department of the Interior
National Park Service

Coppola House (Guilderland MRA)
Albany County
NEW YORK

Working No. 9/29/82-2682

Fed. Reg. Date: 2/1/83

Date Due: 10/29/82 - 11/13/82

Action: ☒ ACCEPT 4/10/82

☐ RETURN

Entered in the ☐ REJECT

National Register

Federal Agency: _____

- ☐ resubmission
☐ nomination by person or local government
☐ owner objection
☐ appeal

Substantive Review: ☐ sample ☐ request ☐ appeal ☐ NR decision

Reviewer's comments:

Recom./Criteria _____

Reviewer _____

Discipline _____

Date _____

☐ see continuation sheet

Nomination returned for: ☐ technical corrections cited below
☐ substantive reasons discussed below

1. Name

2. Location

3. Classification

Category	Ownership	Status	Present Use
	Public Acquisition	Accessible	

4. Owner of Property

5. Location of Legal Description

6. Representation in Existing Surveys

has this property been determined eligible? ☐ yes ☐ no

7. Description

Condition		Check one	Check one
<input type="checkbox"/> excellent	<input type="checkbox"/> deteriorated	<input type="checkbox"/> unaltered	<input type="checkbox"/> original site
<input type="checkbox"/> good	<input type="checkbox"/> ruins	<input type="checkbox"/> altered	<input type="checkbox"/> moved date _____
<input type="checkbox"/> fair	<input type="checkbox"/> unexposed		

Describe the present and original (if known) physical appearance

- ☐ summary paragraph
☐ completeness
☐ clarity
☐ alterations/integrity
☐ dates
☐ boundary selection

8. Significance

Period _____ Areas of Significance—Check and justify below

Specific dates _____ Builder/Architect _____

Statement of Significance (in one paragraph)

- ☐ summary paragraph
- ☐ completeness
- ☐ clarity
- ☐ applicable criteria
- ☐ justification of areas checked
- ☐ relating significance to the resource
- ☐ context
- ☐ relationship of integrity to significance
- ☐ justification of exception
- ☐ other

9. Major Bibliographical References

10. Geographical Data

Acreage of nominated property _____

Quadrangle name _____

UNIT References

Verbal boundary description and justification

11. Form Prepared By

12. State Historic Preservation Officer Certification

The evaluated significance of this property within the state is:

☐ national ☐ state ☐ local

State Historic Preservation Officer signature

Title _____ date _____

13. Other

- ☐ Maps
- ☐ Photographs
- ☐ Other

Questions concerning this nomination may be directed to _____

Signed _____ Date _____ Phone: 202 272-3504

Comments for any item may be continued on an attached sheet

HISTORIC RESOURCES AT
GUILDERLAND (PHASE I)
COPPOLA RESIDENCE (BUDG. # 34)
GUILDERLAND, NY
ALBANY CO., NY



Looking west from
Leesome Lane



Detail of front door
(east elevation)



Detail of front porch
(east elevation)

Historic Resources of
Guilderland (Phase I)
Guilderland, New York
Albany County
COPPOLA RESIDENCE
BLDG. #34
Detail of chimney



Detail of eastern
gable end



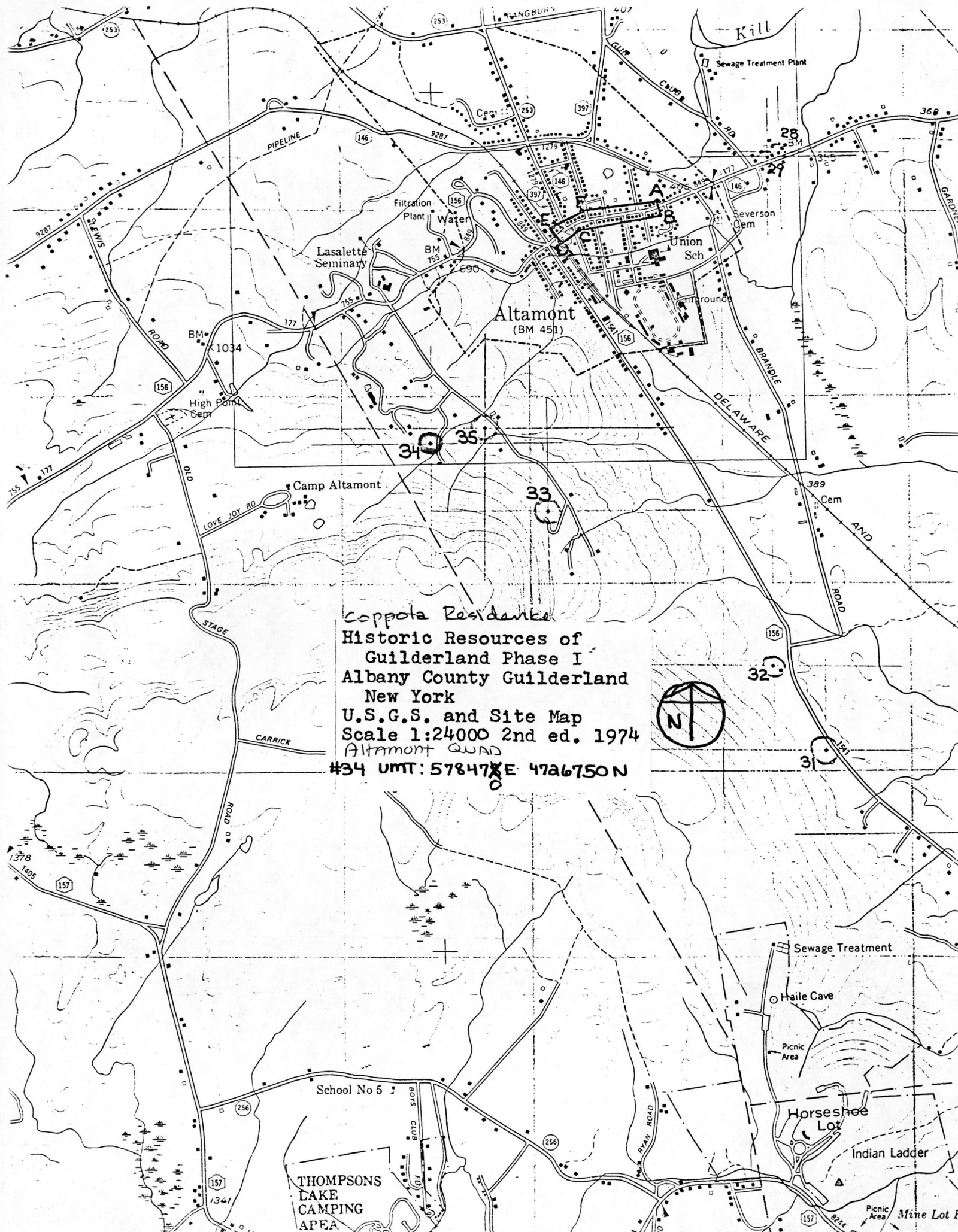

Coppola Residence
Historic Resources of
Guilderland Phase I
Albany County Guilderland
New York
U.S.G.S. and Site Map
Scale 1:24000 2nd ed. 1974
Altamont QUAD
#34 UMT: 578478E 4726750N