

BUILDING-STRUCTURE INVENTORY FORM

DIVISION FOR HISTORIC PRESERVATION
NEW YORK STATE PARKS AND RECREATION
ALBANY, NEW YORK (518) 474-0479

FOR OFFICE USE ONLY

UNIQUE SITE NO. 001-06-0135

QUAD _____

SERIES _____

NEG. NO. _____

YOUR NAME Town of Guilderland

DATE: June 1, 1979

YOUR ADDRESS Town Hall, Guilderland TELEPHONE: 518-356-1980

N.Y.

ORGANIZATION (if any): _____

IDENTIFICATION

1. BUILDING NAME(S): McNiven Farm Complex (Building#27)

2. COUNTY: Albany TOWN/CITY: Guilderland VILLAGE: _____

3. STREET LOCATION: 4178 Altamont Rd

4. OWNERSHIP: a. public ☐ b. private ☒

5. PRESENT OWNER: Roy McNiven ADDRESS: 4178 Altamont Rd., Altamont, N.Y.

6. USE: Original Farmhouse

Present: Farmhouse

12009

7. ACCESSIBILITY TO PUBLIC: Exterior visible from public road: Yes ☒ No ☐

Interior accessible: Explain by appointment

DESCRIPTION

8. BUILDING MATERIAL: a. clapboard ☒ b. stone ☐ c. brick ☐ d. board-and batten ☐
e. cobblestone ☐ f. shingles ☐ g. stucco ☐ other: _____

9. STRUCTURAL SYSTEM (if known): a. wood frame with interlocking joints ☒
b. wood frame with light members ☐
c. masonry load bearing walls ☐
d. metal (explain) _____
e. other _____

10. CONDITION: a. excellent ☒ b. good ☐ c. fair ☐ d. deteriorated ☐

11. INTEGRITY: a. original site ☒ b. moved ☐ if so, when? _____

c. list major alterations and dates (if known): _____

12. PHOTO:

13. MAP

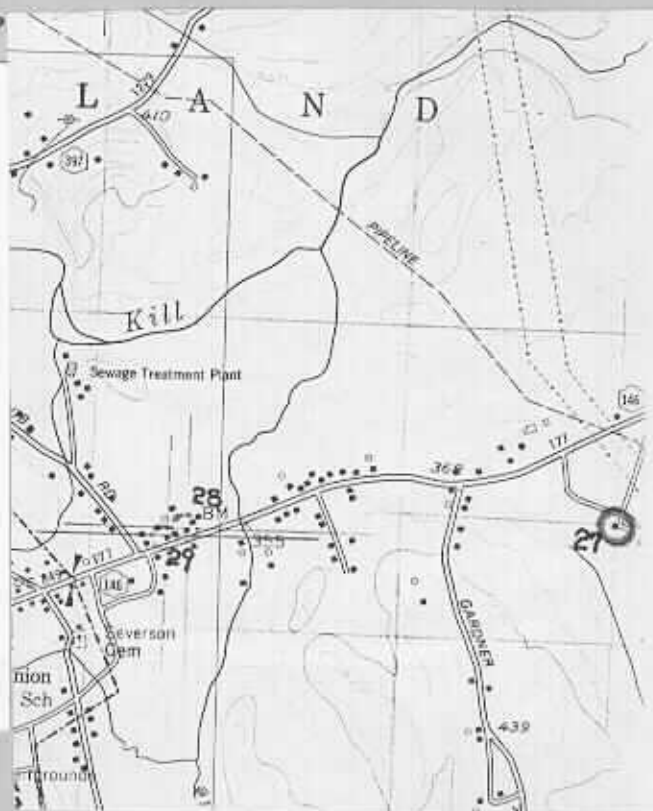

14. THREATS TO BUILDING: a. none known ☒ b. zoning ☐ c. roads ☐
d. developers ☐ e. deterioration ☐
f. other: _____
15. RELATED OUTBUILDINGS AND PROPERTY:
a. barn ☒ b. carriage house ☐ c. garage ☐
d. privy ☐ e. shed ☐ f. greenhouse ☐
g. shop ☐ h. gardens ☐
i. landscape features: _____
j. other: _____
16. SURROUNDINGS OF THE BUILDING (check more than one if necessary):
a. open land ☒ b. woodland ☐
c. scattered buildings ☐
d. densely built-up ☐ e. commercial ☐
f. industrial ☐ g. residential ☐
h. other: Power lines

17. INTERRELATIONSHIP OF BUILDING AND SURROUNDINGS:
(Indicate if building or structure is in an historic district)
Set very far off the road; still retains its original farm setting.

18. OTHER NOTABLE FEATURES OF BUILDING AND SITE (including interior features if known):
Two-story farmhouse, five bays wide with center entrance and gable roof; one-story porch across front extending east to form a porte-cochere; two-story ell on rear; interior remains largely unaltered; evidence of a small 18th-century house on rear.

SIGNIFICANCE

19. DATE OF INITIAL CONSTRUCTION: ca. 1860 (rear 1790's)
- ARCHITECT: Unknown
- BUILDER: Unknown

20. HISTORICAL AND ARCHITECTURAL IMPORTANCE:
The original building was a small Dutch house located to the rear of the present structure. As the farm grew the substantial addition was constructed in the 1860's. The house is largely unaltered and is an excellent example of restrained rural farmhouse of the 19th century. It reflects Guilderland's heritage as a rural, agrarian community of the eighteenth and nineteenth centuries. The barn complex is of a notable vernacular design. Both the farmhouse and barns survive amidst contemporary suburban development. The buildings display a significant degree of integrity.

21. SOURCES: **See bibliography**

22. THEME:

Historic Resources of
Guilderland (Phase I)
McNiven Farm Complex

The house looking
south from
Altamont Road



Barns to the east
of the house

Aug 7-12

4178 Altamont Road

Building #27

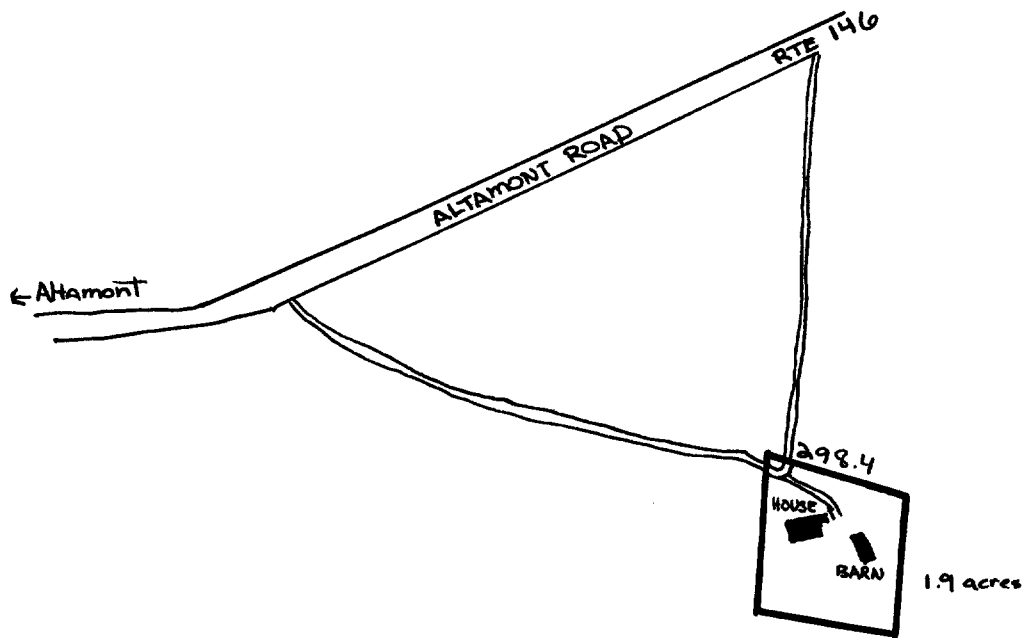

McNiven Farm Complex
Historic Resources of
Guilderland Phase I
Albany County Guilderland
New York
Site Map (from tax map)
Smith & Mahoney 1979

1" = 400'

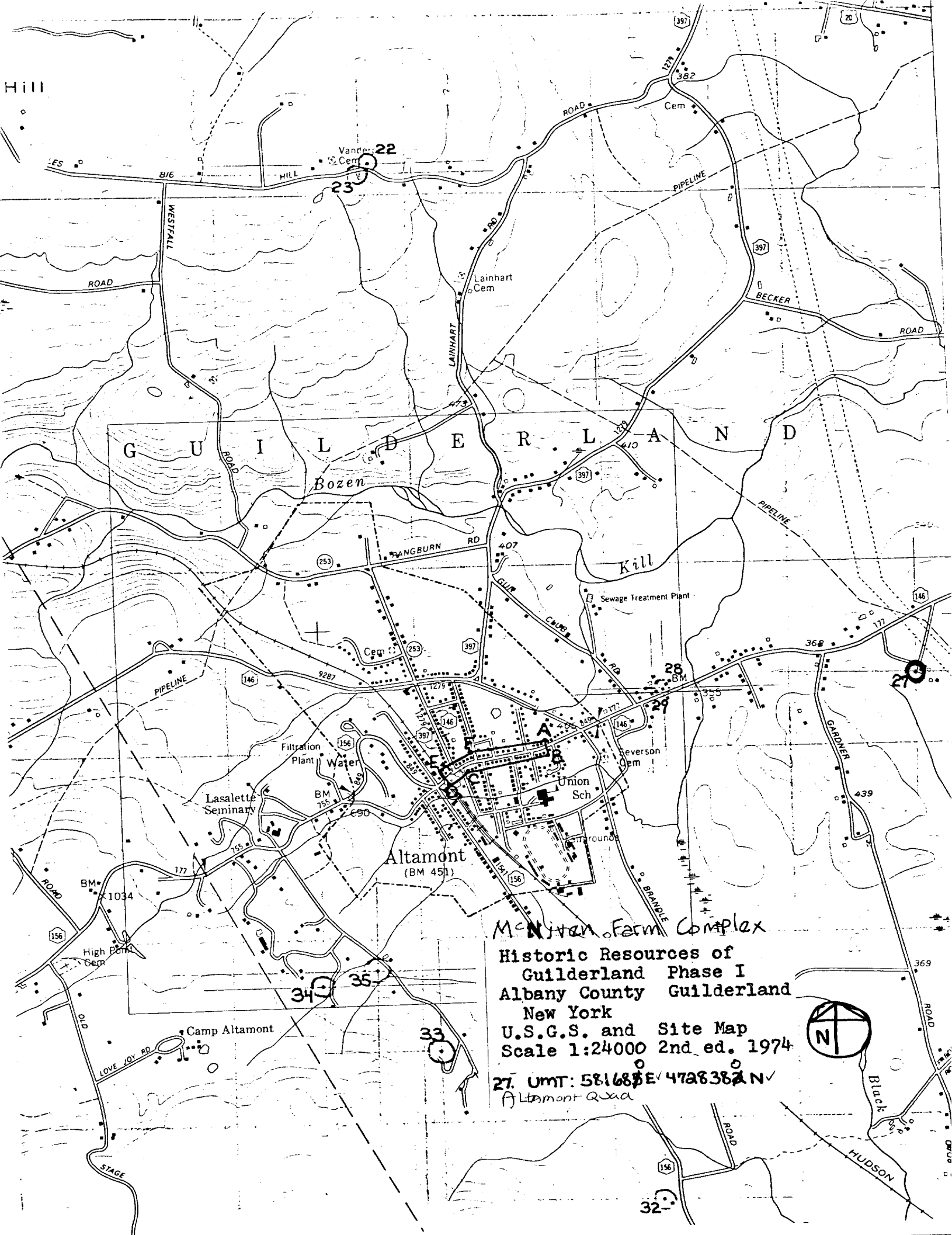

McNittan Farm Complex
Historic Resources of
Guiderland Phase I
Albany County Guiderland
New York
U.S.G.S. and Site Map
Scale 1:24000 2nd ed. 1974
27. UMT: 581685E 4728382N
Altamont Quad

