

BUILDING-STRUCTURE INVENTORY FORM

DIVISION FOR HISTORIC PRESERVATION
NEW YORK STATE PARKS AND RECREATION
ALBANY, NEW YORK (518) 474-0479

FOR OFFICE USE ONLY

UNIQUE SITE NO. 001-06-0137

QUAD _____

SERIES _____

NEG. NO. _____

YOUR NAME: Town of Guilderland DATE: June 1, 1979

YOUR ADDRESS: Town Hall, Guilderland TELEPHONE: 518-356-1980
N.Y.

ORGANIZATION (if any): _____

IDENTIFICATION

1. BUILDING NAME(S) Knower House (Building #29)
2. COUNTY: Albany TOWN/CITY: Guilderland VILLAGE: Altamont VIC.
3. STREET LOCATION: 3921 Altamont Rd
4. OWNERSHIP: a. public ☐ b. private ☒
5. PRESENT OWNER Edward Gee ADDRESS: 3921 Altamont Rd. Altamont, N.Y.
6. USE: Original: residence Present: residence 12009
7. ACCESSIBILITY TO PUBLIC: Exterior visible from public road: Yes ☒ No ☐
Interior accessible: Explain by appointment

DESCRIPTION

8. BUILDING MATERIAL: a. clapboard ☐ b. stone ☐ c. brick ☐ d. board and batten ☐
e. cobblestone ☐ f. shingles ☐ g. stucco ☐ other asbestos shingles
9. STRUCTURAL SYSTEM: a. wood frame with interlocking joints ☒
(if known) b. wood frame with light members ☐
c. masonry load bearing walls ☐
d. metal (explain) _____
e. other _____
10. CONDITION: a. excellent ☐ b. good ☒ c. fair ☐ d. deteriorated ☐
11. INTEGRITY: a. original site ☒ b. moved ☐ if so, when? _____
c. list major alterations and dates (if known):
shingles ca. 1950

12. PHOTO:

13. MAP:



14. THREATS TO BUILDING: a. none known ☒ b. zoning ☐ c. roads ☐
d. developers ☐ e. deterioration ☐
f. other: _____
15. RELATED OUTBUILDINGS AND PROPERTY:
a. barn ☐ b. carriage house ☐ c. garage ☒ (not historic)
d. privy ☐ e. shed ☐ f. greenhouse ☐
g. shop ☐ h. gardens ☐
i. landscape features: _____
j. other: _____
16. SURROUNDINGS OF THE BUILDING (check more than one if necessary):
a. open land ☐ b. woodland ☒
c. scattered buildings ☒
d. densely built-up ☐ e. commercial ☐
f. industrial ☐ g. residential ☒
h. other: _____
17. INTERRELATIONSHIP OF BUILDING AND SURROUNDINGS:
(Indicate if building or structure is in an historic district)
The house is located in what was the center of the village along the Schoharie plank road and is located next to the Crounse Inn.
18. OTHER NOTABLE FEATURES OF BUILDING AND SITE (including interior features if known):
This two-story Georgian Colonial house is five bays wide with center entrance with Palladian window above. Although presently sided with asbestos shingles, the owner is starting to remove the shingles and restore the original clapboards; the interior retains much of the original features including hand-carved decorations on mantels, large central hall with elliptical
SIGNIFICANCE
19. DATE OF INITIAL CONSTRUCTION: ca. 1800 (See continuation)
ARCHITECT: unknown
BUILDER: unknown
20. HISTORICAL AND ARCHITECTURAL IMPORTANCE:
This house was constructed for Benjamin Knowler, a prominent businessman and banker for whom the village was named after his death. (Knowersville became Altamont in 1887 when the Post Office requested the change to avoid confusion with another town.) Knowler was a hatter by trade and developed a waterproofing method for his beaver-skin hats. It is believed that the room in the western side of the second floor was used as a display room because of the unusual barrel vaulted ceiling and handcrafted peg boards around the entire room. William L. Marcy, who later became governor of the State and U.S. Secretary of State, married Cornelia Knowler in the grand hall of this
21. SOURCES: Interview with owner, house in 1824.
Albany County Clerk's Office,
See bibliography
22. THEME:

Knower House

Albany Co., NY

For HCRS use only

received

date entered

**United States Department of the Interior
Heritage Conservation and Recreation Service****National Register of Historic Places
Inventory—Nomination Form**

Continuation sheet Building Number 29

Item number 18

Page 2

arch and carved newel post, raised paneled doors with original strap hinges.

Although the exterior has been covered with asbestos shingles, many significant architectural details remain intact. A central, second story tripartite window, cornice returns, a carved newel post on the interior staircase, and delicate interior mouldings contribute to the character of the building. The structure survives amidst modern suburban development and is particularly significant relative to these surroundings.

Historic Resources of
Guilderland (Phase I)
Guilderland, New York
Albany County
Knower House

Detail of newel post in the
central hall.



• 101 • 30

Detail of hardware on front
door.



• 101 • 30

Historic Resources of
Guilderland (Phase I)

Knower House
Guilderland, NY
Albany Co.

Detail of archway in the central
hall.

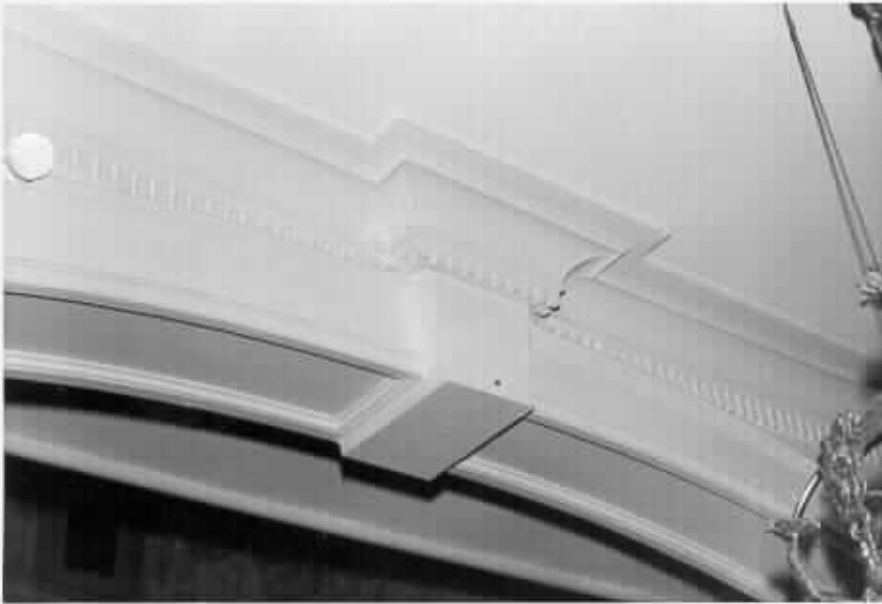

Fireplace in the first story
east parlor.

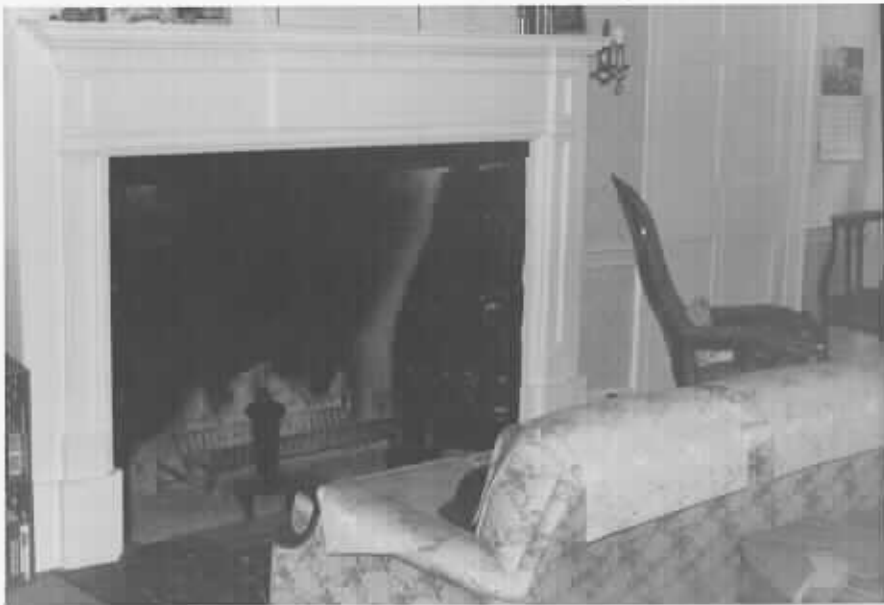

Detail of carved decoration on
mantel in the east parlor.

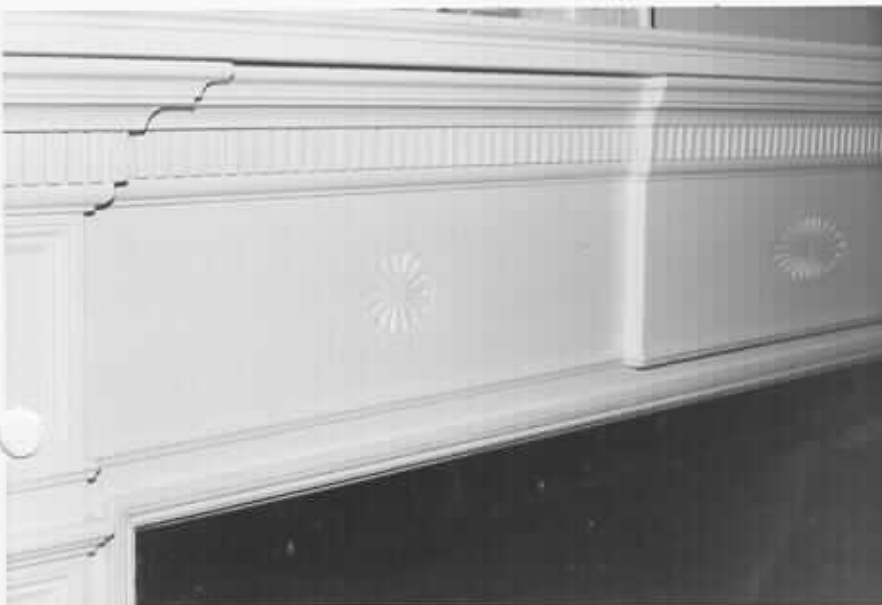

Building #29

N↑

1"=200'

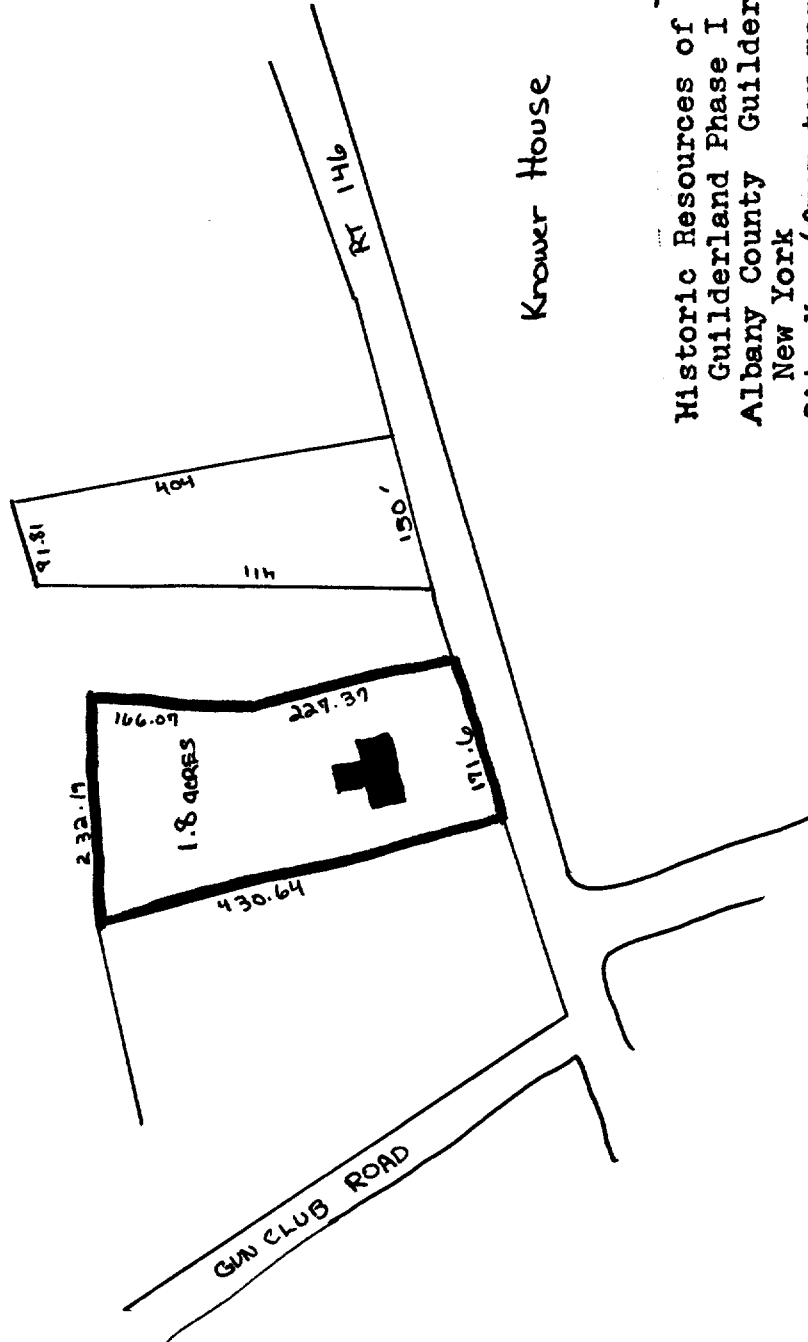

Krower House

Historic Resources of
Guilderland Phase I
Albany County Guilderland
New York
Site Map (from tax map)
Smith & Mahoney 1979

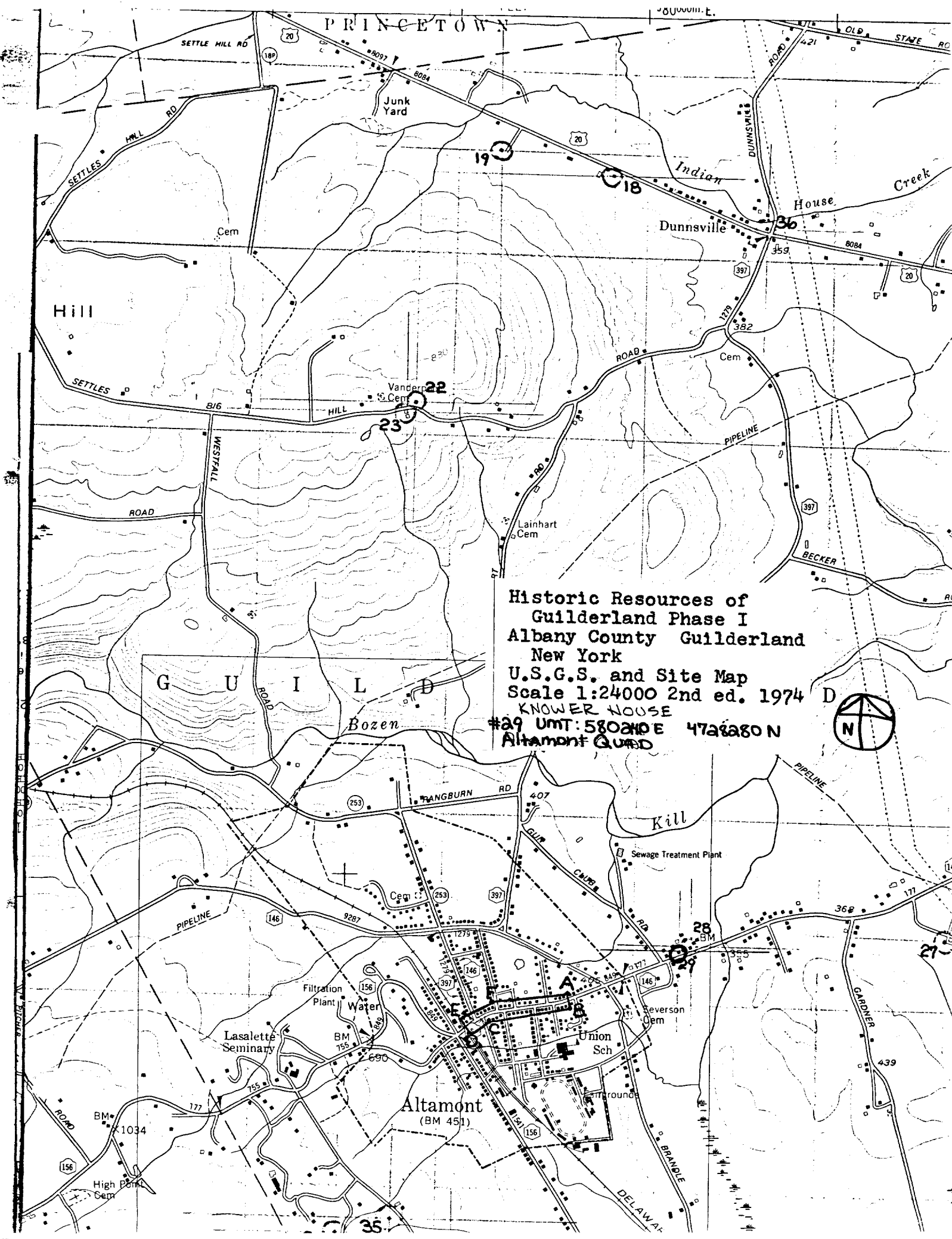

Historic Resources of
Guilderland Phase I
Albany County Guilderland
New York

U.S.G.S. and Site Map
Scale 1:24000 2nd ed. 1974 D

KNOWER HOUSE
#29 UMT: 580210 E 47a1a80 N
Altamont Quad



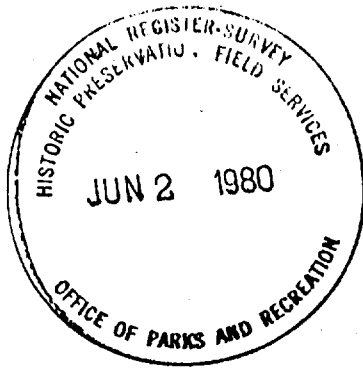

EDWARD O. BEE
RD #1 Box 12
ALTAMONT N.Y.
12007

DEAR MR LEHMAN:

I wish to provide you with
ADDITIONAL information on the KNOWER-
HOUSE LOCATED in ALTAMONT N.Y.
ENCLOSED you will find a copy from
THE BOOK THAT THE TOWN HISTORIAN
(MR ARTHUR BEE) WROTE SOME
TIME AGO. IT INCLUDES DATES
ETC. I WOULD LIKE OUR HOUSE
TO BE INCLUDED in THE NATIONAL
REGISTER AS IT DOES REPRESENTS
ONE of THE FIRST HOUSES in
THE AREA.

MR KNOWER WAS THE
founder of ALTAMONT which WAS
CALLED KNOWERSVILLE AT THE TIME
I HAVE SPENT A CONSIDERABLE
AMOUNT of MONEY RESTORING
THE HOUSE AND AM VERY
OVER

Proud of the outcome.

I would BE honored TO
HAVE THE KNOWER HOUSE LISTED
AND WILL CONTINUE TO WORK
TO PRESERVE IT'S HISTORY

Sincerely
EDWARD OBBE