

BUILDING-STRUCTURE INVENTORY FORM

DIVISION FOR HISTORIC PRESERVATION
NEW YORK STATE PARKS AND RECREATION
ALBANY, NEW YORK (518) 474-0479

FOR OFFICE USE ONLY

UNIQUE SITE NO. 001-06-0124
QUAD _____
SERIES _____
NEG. NO. _____

YOUR NAME: Town of Guilderland DATE: June 1, 1979

YOUR ADDRESS: Town Hall, Guilderland TELEPHONE: _____
N.Y.

ORGANIZATION (if any): _____

IDENTIFICATION

1. BUILDING NAME(S): Hamilton Union Presbyterian Church (Building #5)
2. COUNTY Albany TOWN/CITY Guilderland VILLAGE: _____
3. STREET LOCATION: 2291 Western Tr
4. OWNERSHIP: a. public ☐ b. private ☒
5. PRESENT OWNER: Trustees, H.U.P.C. ADDRESS: Box 151 Guilderland, N.Y. 12084
6. USE: Original: church Present: church
7. ACCESSIBILITY TO PUBLIC: Exterior visible from public road: Yes ☒ No ☐
Interior accessible: Explain Sundays and by appointment

DESCRIPTION

8. BUILDING MATERIAL: a. clapboard ☒ b. stone ☐ c. brick ☐ d. board and batten ☐
e. cobblestone ☐ f. shingles ☐ g. stucco ☐ other: _____
9. STRUCTURAL SYSTEM: a. wood frame with interlocking joints ☐
(if known) b. wood frame with light members ☒
c. masonry load bearing walls ☐
d. metal (explain) _____
e. other buttresses on side walls
10. CONDITION: a. excellent ☒ b. good ☐ c. fair ☐ d. deteriorated ☐
11. INTEGRITY: a. original site ☒ b. moved ☐ if so, when? _____
c. list major alterations and dates (if known):
1972 - interior partition removed and structural tie-rods installed
1963 - education annex constructed
12. PHOTO: _____
13. MAP: _____



HP-1



14. THREATS TO BUILDING: a. none known ☒ b. zoning ☐ c. roads ☐
d. developers ☐ e. deterioration ☐
f. other: _____
15. RELATED OUTBUILDINGS AND PROPERTY:
a. barn ☐ b. carriage house ☐ c. garage ☐
d. privy ☐ e. shed ☐ f. greenhouse ☐
g. shop ☐ h. gardens ☐
i. landscape features: parking lot on south side
j. other: educational annex 1963
16. SURROUNDINGS OF THE BUILDING (check more than one if necessary):
a. open land ☐ b. woodland ☐
c. scattered buildings ☒
d. densely built-up ☐ e. commercial ☐
f. industrial ☐ g. residential ☒
h. other: _____

17. INTERRELATIONSHIP OF BUILDING AND SURROUNDINGS:

(Indicate if building or structure is in an historic district)

The church is set back from Western Avenue and is located in a residential area.

18. OTHER NOTABLE FEATURES OF BUILDING AND SITE (including interior features if known):

The Stick Style church has a large open bell tower on the south side. The building has an unusual structural design that incorporates buttresses to compensate for the lack of roof trusses. The interior retains the original pews and red pine woodwork.

SIGNIFICANCE

19. DATE OF INITIAL CONSTRUCTION: 1886

ARCHITECT: August Howe

BUILDER: Howard P. Foster & Martin Talmage

20. HISTORICAL AND ARCHITECTURAL IMPORTANCE:

The church was constructed in 1886 and designed by New York City architect August Howe. The church has been supported since 1797 by the hamlet of Hamiltonville and is the third church building on this site. The church is unusual in its departure from standard ecclesiastical design. The main entrance is located on the side of the nave beneath a Stick style tower with a belfry. A bracketed cornice surrounds the building and tower. Simple buttresses punctuate the side walls. The handsome stained-glass windows were crafted by Charles P. Davis of Utica, NY. The exterior of the original structure is in excellent condition and is substantially intact. The church is historically

21. SOURCES: History of Hamilton Union Church: W. & M. Embler, 1974

22. THEME:

Historic Resources of Guilderland (Phase I)
Guilderland, NY
Albany County
Hamilton Union Presbyterian Church (Building #5)

continuation sheet

20. and architecturally significant as the social and visual focus of Hamilton-
ville.



Historic Resources of
Guilderland (Phase 1)
Guilderland, New York
Albany County

Building #5
HAMILTON UNION PRESBYTERIAN
CHURCH

Detail of open belfry

Detail of carved
detailing

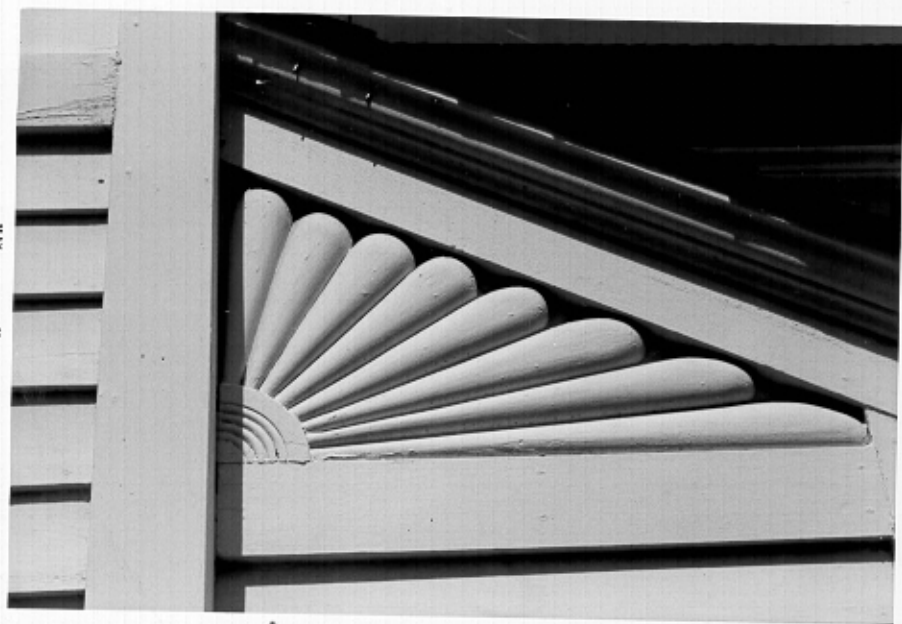

HAMILTON UNION PRES-
BYTERIAN CHURCH
Historic Resources of
Guilderland (Phase I)
Guilderland, New York
Albany County

Building #5



Non-contributing addition

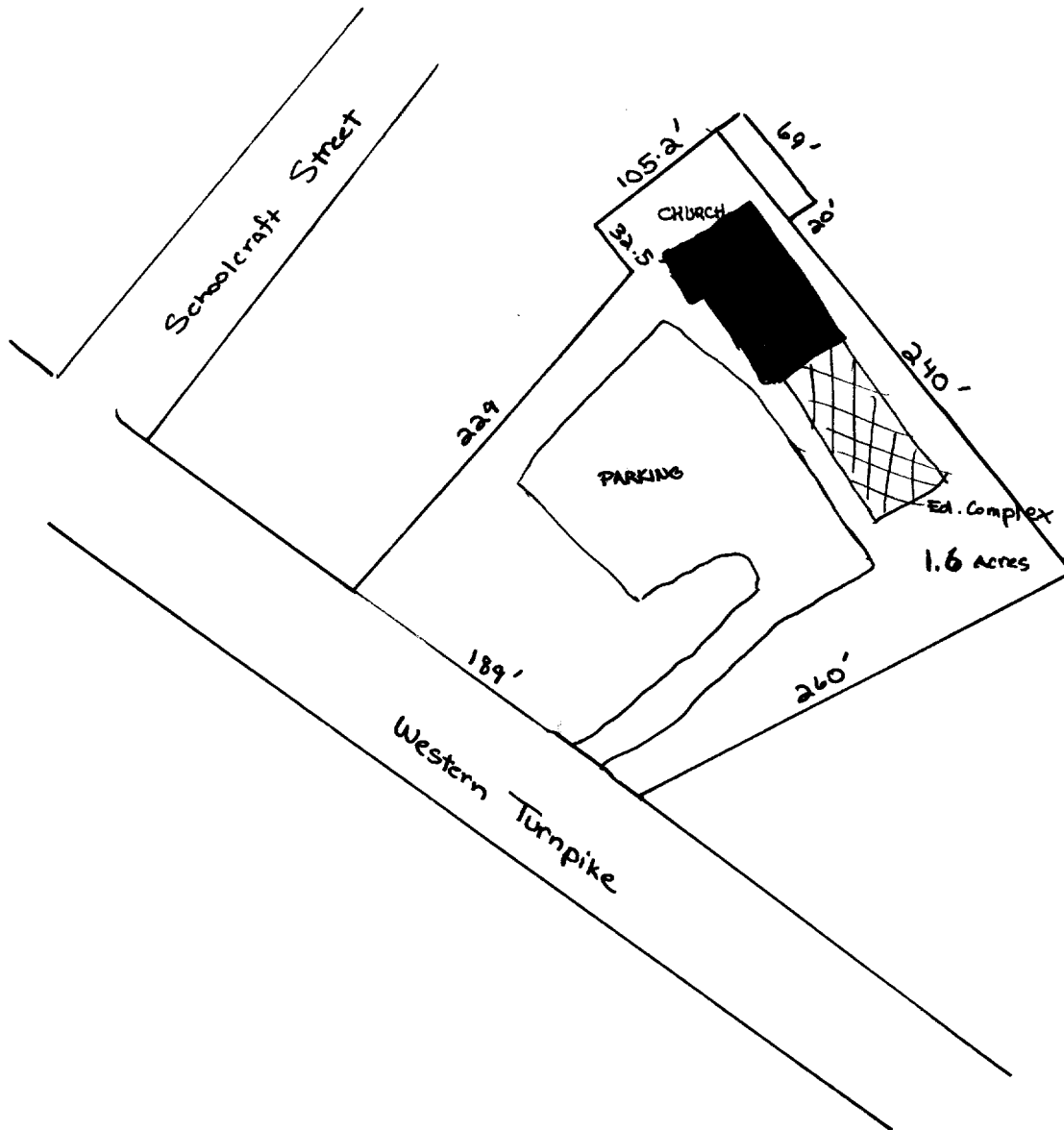

1"=100'

Historic Resources of
Guilderland Phase I
Albany County Guilderland
New York
Site Map (from tax map)
Smith & Mahoney 1979

