

# BUILDING-STRUCTURE INVENTORY FORM

DIVISION FOR HISTORIC PRESERVATION  
NEW YORK STATE PARKS AND RECREATION  
ALBANY, NEW YORK (518) 474-0479

FOR OFFICE USE ONLY

UNIQUE SITE NO. 001-06-0140  
QUAD \_\_\_\_\_  
SERIES \_\_\_\_\_  
NEG. NO. \_\_\_\_\_

ACROSS 101  
JUSTIFIED  
(EIDAC)

YOUR NAME: Town of Guilderland DATE: June 1, 1979

YOUR ADDRESS: Town Hall Guilderland TELEPHONE: 518-356-1980  
N.Y.

ORGANIZATION (if any): \_\_\_\_\_

## IDENTIFICATION

1. BUILDING NAME(S): Frederick Crounse House (Building #32)  
2. COUNTY Albany TOWN/CITY Guilderland VILLAGE: \_\_\_\_\_  
3. STREET LOCATION 3960 Altamont-Voorheesville RD  
4. OWNERSHIP: a. public ☐ b. private ☒  
5. PRESENT OWNER: A. G. Gabriels ADDRESS: Box 462 R.D.2, Altamont, N.Y.  
6. USE: Original: residence Present: residence 12009  
7. ACCESSIBILITY TO PUBLIC: Exterior visible from public road: Yes ☒ No ☐  
Interior accessible: Explain by appointment

## DESCRIPTION

8. BUILDING MATERIAL: a. clapboard ☒ b. stone ☐ c. brick ☐ d. board and batten ☐  
e. cobblestone ☐ f. shingles ☐ g. stucco ☐ other: \_\_\_\_\_  
9. STRUCTURAL SYSTEM (if known): a. wood frame with interlocking joints ☒  
b. wood frame with light members ☐  
c. masonry load bearing walls ☐  
d. metal (explain) \_\_\_\_\_  
e. other \_\_\_\_\_  
10. CONDITION: a. excellent ☐ b. good ☒ c. fair ☐ d. deteriorated ☐  
11. INTEGRITY: a. original site ☒ b. moved ☐ if so, when? \_\_\_\_\_  
c. list major alterations and dates (if known): \_\_\_\_\_

12. PHOTO:

13. MAP:



14. THREATS TO BUILDING: a. none known ☒ b. zoning ☐ c. roads ☐  
 d. developers ☐ e. deterioration ☐  
 f. other: \_\_\_\_\_
15. RELATED OUTBUILDINGS AND PROPERTY:  
 a. barn ☒ b. carriage house ☐ c. garage ☒ (not historic)  
 d. privy ☐ e. shed ☐ f. greenhouse ☐  
 g. shop ☐ h. gardens ☐  
 i. landscape features: \_\_\_\_\_  
 j. other: \_\_\_\_\_
16. SURROUNDINGS OF THE BUILDING (check more than one if necessary):  
 a. open land ☒ b. woodland ☒  
 c. scattered buildings ☐  
 d. densely built-up ☐ e. commercial ☐  
 f. industrial ☐ g. residential ☐  
 h. other: small pond

17. INTERRELATIONSHIP OF BUILDING AND SURROUNDINGS:

(Indicate if building or structure is in an historic district)

**Set back from road, it retains its 18th-century setting. Another Crounse house is located to south. Since the original farm is now mostly woodland, the nominated area is an arbitrary 8 acres surrounding the house.**

18. OTHER NOTABLE FEATURES OF BUILDING AND SITE (including interior features if known):

**There is evidence in the farmhouse of the evolution of three separate structures. A small Dutch stone house is at the rear, and a late 18th-century wing was added to that. The main house was built around 1802 and retains much of the original detail in the stairs, mantelpieces and woodwork.**

SIGNIFICANCE

19. DATE OF INITIAL CONSTRUCTION: ca. 1760, ca. 1780, ca. 1802

ARCHITECT: Unknown

BUILDER: Unknown

20. HISTORICAL AND ARCHITECTURAL IMPORTANCE:

**This substantial farmhouse was built in three stages beginning with a small stone Dutch house built around 1760. The house was lived in by Frederick Crounse and records seem to indicate the second addition was added by his son Frederick 2nd. Frederick Crounse 2nd was very patriotic during the Revolutionary War and contributed liberally toward the support of the American cause. Frederick 2nd was also believed responsible for the 1802 addition. The Crounse House is significant as one of the earliest structures in the town, as well as for its Federal period additions and for its association with a notable community figure. Its early barn contributes to the character of the farmhouse.**

21. SOURCES: **See bibliography**

22. THEME:

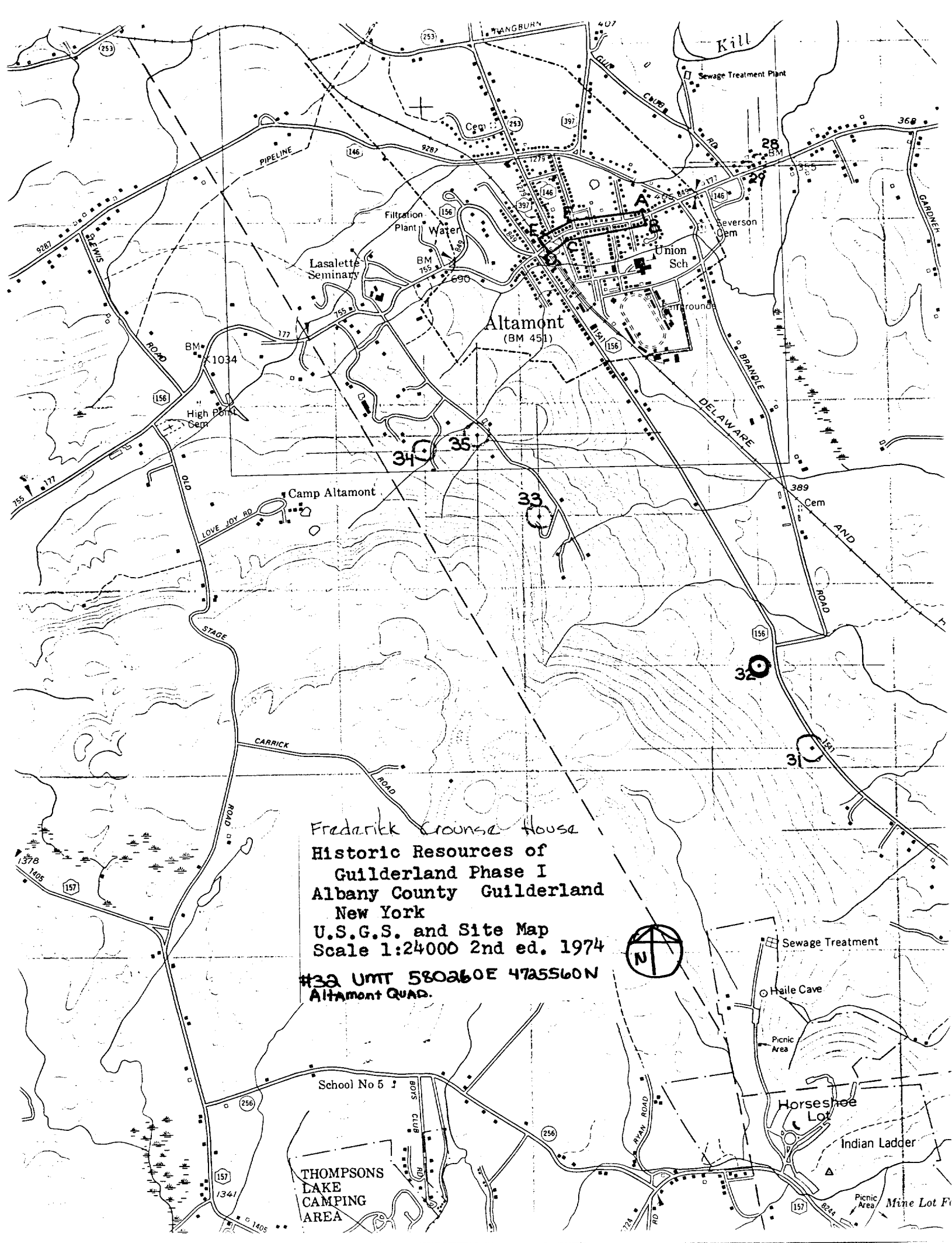

Frederick Crouse House  
Historic Resources of  
Guilderland Phase I  
Albany County Guilderland  
New York  
U.S.G.S. and Site Map  
Scale 1:24000 2nd ed. 1974  
#32 UMT 580260E 4725560N  
Altamont Quad.



3960 Altamont-Voorheesville Rd.

Building # 32

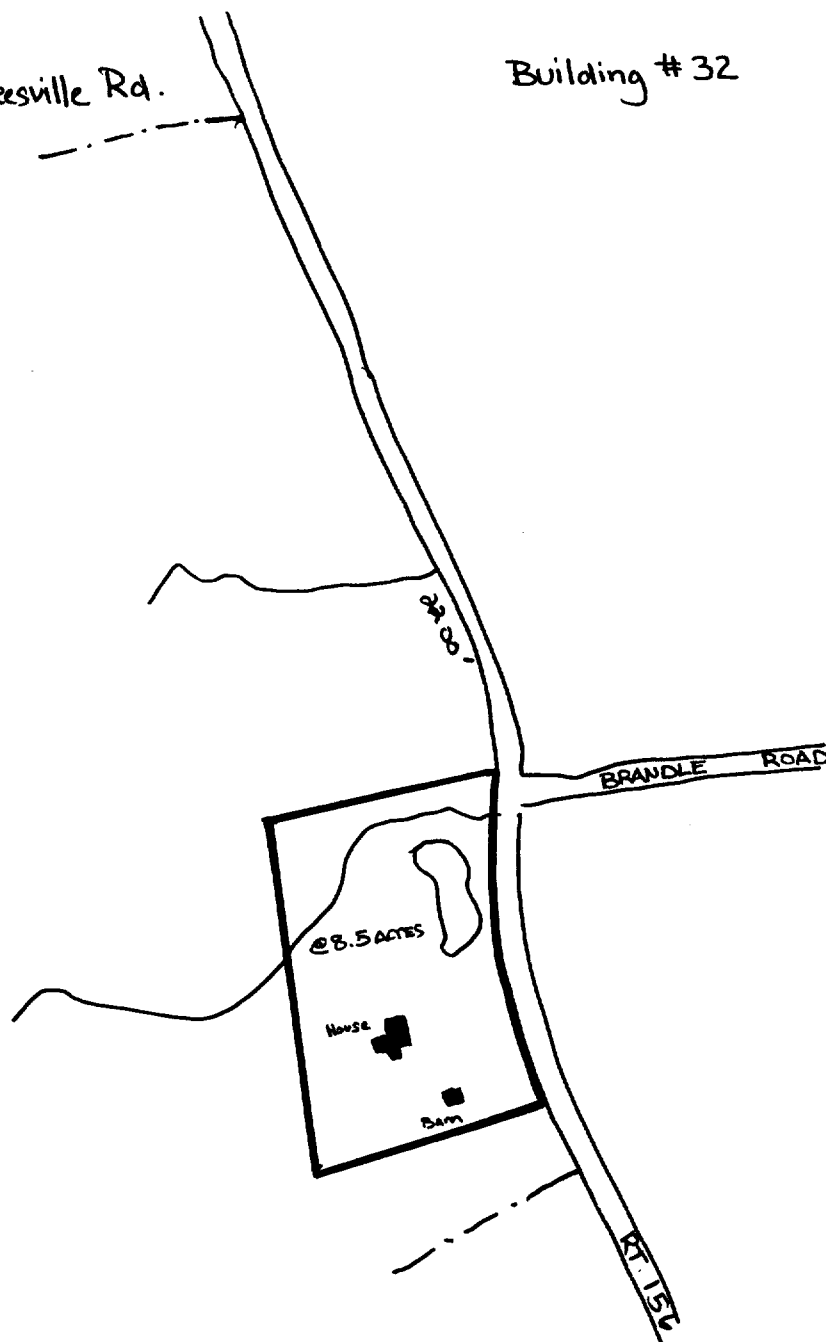

Frederick Crouse House

Historic Resources of  
Guilderland Phase I  
Albany County Guilderland  
New York  
Site Map (from tax map)  
Smith & Mahoney 1979

N ↑

1" = 400'

Historic Resources of  
Guilderland (Phase I)  
Guilderland, New York  
Albany County

Fraderick Crounsa House



Barns & garages  
southeast of property

East of property  
looking east,  
showing original  
section