

# BUILDING-STRUCTURE INVENTORY FORM

DIVISION FOR HISTORIC PRESERVATION  
NEW YORK STATE PARKS AND RECREATION  
ALBANY, NEW YORK (518) 474-0479

FOR OFFICE USE ONLY

UNIQUE SITE NO. 001-06-0161  
QUAD \_\_\_\_\_  
SERIES \_\_\_\_\_  
NEG. NO. \_\_\_\_\_

YOUR NAME: Town of Guilderland DATE: June 1, 1979

YOUR ADDRESS: Town Hall, Guilderland, N.Y. TELEPHONE: 518-356-1980

ORGANIZATION (if any): \_\_\_\_\_

## IDENTIFICATION

1. BUILDING NAME(S): Chapel House / (Building #1)  
2. COUNTY: Albany TOWN/CITY: Guilderland VILLAGE: \_\_\_\_\_  
3. STREET LOCATION: Western Ave NORTH SIDE AT S.U.N.Y.A. ; EAST OF RTE. 156  
4. OWNERSHIP: a. public ☐ b. private ☒ 16 Waverly Place  
5. PRESENT OWNER: Albany Collegiate ADDRESS: Albany, N.Y. 12203  
6. USE: Original: Residence Present: ecumenical chapel  
7. ACCESSIBILITY TO PUBLIC: Exterior visible from public road: Yes ☒ No ☐  
Interior accessible: Explain yes

## DESCRIPTION

8. BUILDING MATERIAL: a. clapboard ☐ b. stone ☐ c. brick ☐ d. board and batten ☐  
e. cobblestone ☐ f. shingles ☐ g. stucco ☒ other: \_\_\_\_\_  
9. STRUCTURAL SYSTEM: a. wood frame with interlocking joints ☐  
(if known) b. wood frame with light members ☒  
c. masonry load bearing walls ☐  
d. metal (explain) \_\_\_\_\_  
e. other \_\_\_\_\_  
10. CONDITION: a. excellent ☐ b. good ☒ c. fair ☐ d. deteriorated ☐  
11. INTEGRITY: a. original site ☒ b. moved ☐ if so, when? \_\_\_\_\_  
c. list major alterations and dates (if known): \_\_\_\_\_

## 12. PHOTO:

## 13. MAP:

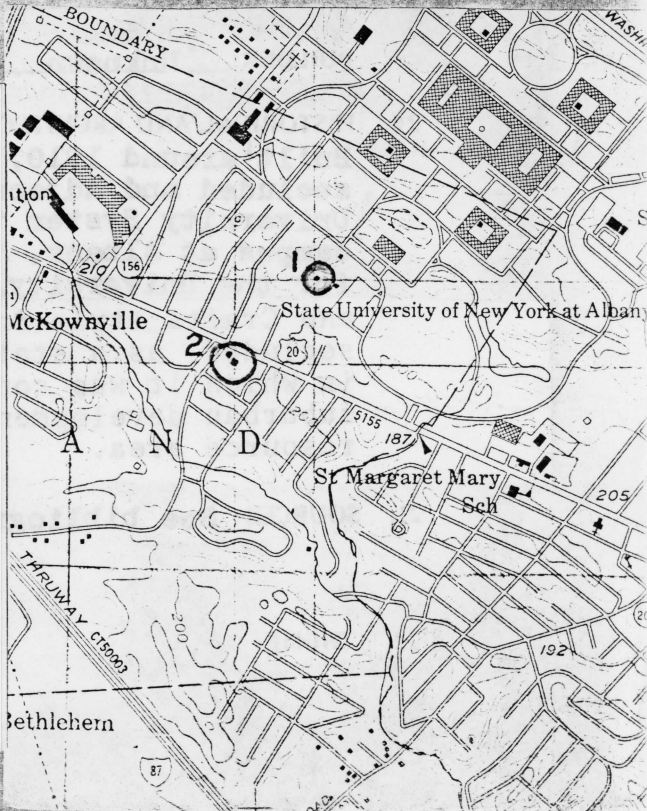

14. THREATS TO BUILDING: a. none known ☒ b. zoning ☐ c. roads ☐  
d. developers ☐ e. deterioration ☐  
f. other: \_\_\_\_\_

15. RELATED OUTBUILDINGS AND PROPERTY:  
a. barn ☐ b. carriage house ☐ c. garage ☐  
d. privy ☐ e. shed ☐ f. greenhouse ☐  
g. shop ☐ h. gardens ☐  
i. landscape features: Heavily wooded area  
j. other: \_\_\_\_\_

16. SURROUNDINGS OF THE BUILDING (check more than one if necessary):  
a. open land ☐ b. woodland ☒  
c. scattered buildings ☐  
d. densely built-up ☐ e. commercial ☐  
f. industrial ☐ g. residential ☐  
h. other: \_\_\_\_\_

17. INTERRELATIONSHIP OF BUILDING AND SURROUNDINGS:  
(Indicate if building or structure is in an historic district)  
**Building is located in a wooded area on the southern edge of the State University at Albany campus.**

18. OTHER NOTABLE FEATURES OF BUILDING AND SITE (including interior features if known):  
**Two-story, Arts and Crafts Style house with stucco walls and half-timbering; asymmetrical plan; hexagonal tower on south side; large overhangs with exposed timbers; grouped casement windows; interior retains some original details.**

**SIGNIFICANCE**

19. DATE OF INITIAL CONSTRUCTION: ca. 1910

ARCHITECT: Unknown

BUILDER: Unknown

20. HISTORICAL AND ARCHITECTURAL IMPORTANCE:  
**Built around 1910, this fine Arts & Crafts Style home was very secluded and adjacent to the Albany Country Club. The State University System took over the course to construct the new campus at Albany. The house is now used as an ecumenical center for the University.** The building is the only example of the Arts and Crafts style in the town. It remains, largely intact and secluded, as a statement of the suburban lifestyle of the period in which it was constructed. Its survival in an area near modern suburban development adds to its significance within the multiple resource area.

21. SOURCES: **See bibliography**

22. THEME:

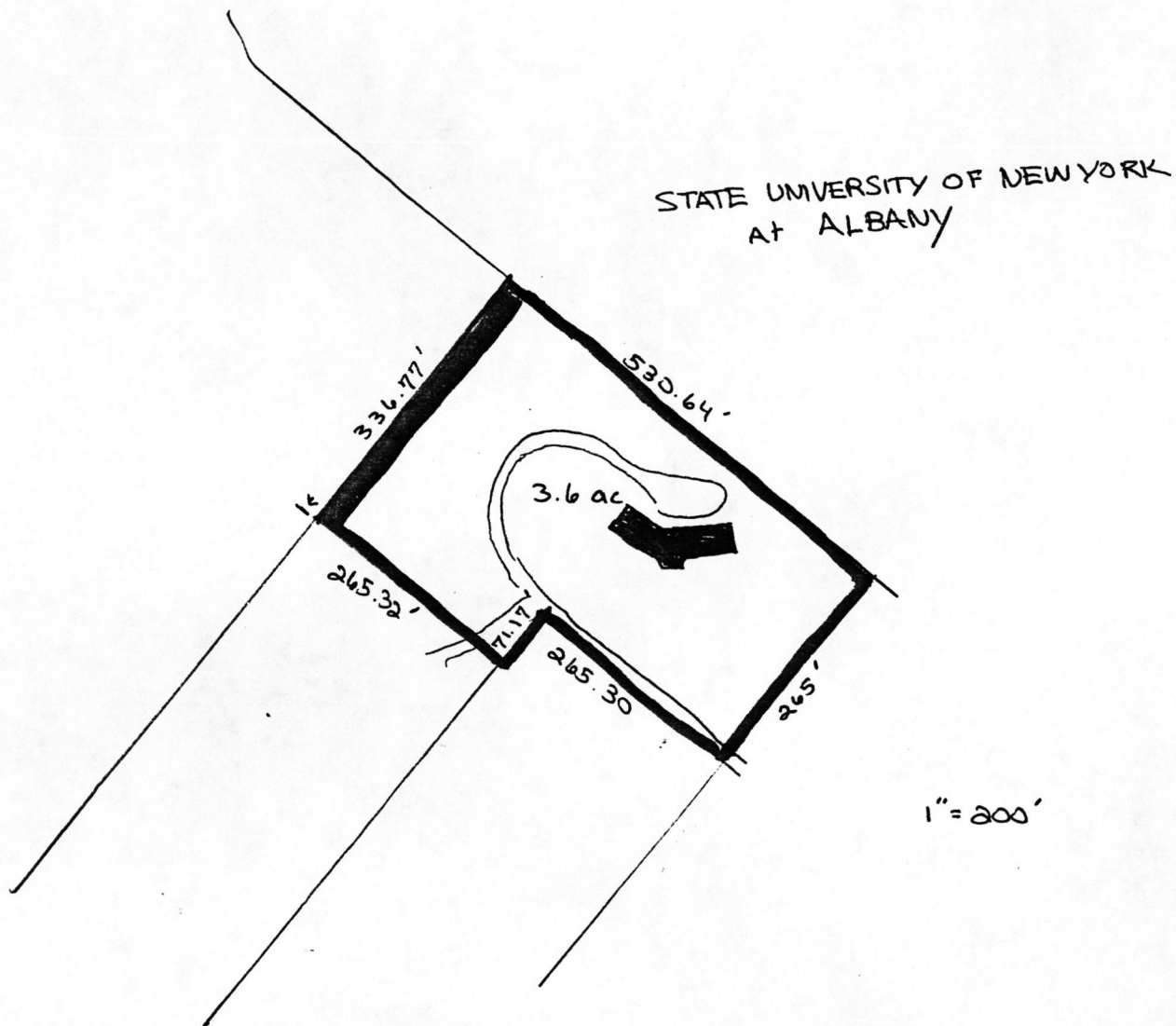

1" = 200'



### CHAPEL HOUSE

Historic Resources of  
Guilderland Phase I  
Albany County Guilderland  
New York  
Site Map (from tax map)  
Smith & Mahoney 1979

WESTERN  
TURNPIKE

United States Department of the Interior  
National Park ServiceNational Register of Historic Places  
Inventory—Nomination Form

For NPS use only

received

date entered

Continuation sheet

Item number

Page 2 of 4

Multiple Resource Area  
Thematic GroupName Guilderland Multiple Resource AreaState New York

Nomination/Type of Review

Date/Signature

11. Aumic House

Entered in the  
National Register

for Keeper

Delores Byers 11/10/82

Attest

12. Coppola House

Entered in the  
National Register

for Keeper

Delores Byers 11/10/82

Attest

13. Schoolcraft, John, House

Entered in the  
National Register

for Keeper

Delores Byers 11/10/82

Attest

14. Helderberg Reformed Dutch  
ChurchEntered in the  
National Register

for Keeper

Delores Byers 11/10/82

Attest

15. Mynderse-Frederick House

Substantive Review

Keeper

James Van Donge 11/10/82

Attest

16. Chapel House

Entered in the  
National Register

for Keeper

Delores Byers 11/10/82

Attest

17. Rose Hill

Entered in the  
National Register

for Keeper

Delores Byers 11/10/82

Attest

18. Hamilton Union Church  
RectoryEntered in the  
National Register

for Keeper

Delores Byers 11/10/82

Attest

19. Hamilton Union Presbyterian  
ChurchEntered in the  
National Register

for Keeper

Delores Byers 11/10/82

Attest

20. Schoolhouse #6

Substantive Review

Keeper

James Van Donge 11/10/82

Attest

United States Department of the Interior  
National Park Service

Chapel House (Guilderland MRA)  
Albany County  
NEW YORK

Working No. 9/29/82-2682

Fed. Reg. Date: 2.1.83

Date Due: 10/29/82 - 11/13/82

Action: ☒ ACCEPT 11/20/82

☐ RETURN

☐ REJECT

Entered in the \_\_\_\_\_  
National Register \_\_\_\_\_

Federal Agency: \_\_\_\_\_

- ☐ resubmission  
☐ nomination by person or local government  
☐ owner objection  
☐ appeal

Substantive Review: ☐ sample ☐ request ☐ appeal ☐ NR decision

Reviewer's comments:

Recom./Criteria \_\_\_\_\_

Reviewer \_\_\_\_\_

Discipline \_\_\_\_\_

Date \_\_\_\_\_

see continuation sheet

Nomination returned for: ☐ technical corrections cited below  
☐ substantive reasons discussed below

### 1. Name

### 2. Location

### 3. Classification

Category	Ownership	Status	Present Use
	Public Acquisition	Accessible	

### 4. Owner of Property

### 5. Location of Legal Description

### 6. Representation in Existing Surveys

has this property been determined eligible? ☐ yes ☐ no

### 7. Description

Condition		Check one	Check one
<input type="checkbox"/> excellent	<input type="checkbox"/> deteriorated	<input type="checkbox"/> unaltered	<input type="checkbox"/> original site
<input type="checkbox"/> good	<input type="checkbox"/> ruins	<input type="checkbox"/> altered	<input type="checkbox"/> moved date _____
<input type="checkbox"/> fair	<input type="checkbox"/> unexposed		

Describe the present and original (if known) physical appearance

- ☐ summary paragraph  
☐ completeness  
☐ clarity  
☐ alterations/integrity  
☐ dates  
☐ boundary selection

## **8. Significance**

Period \_\_\_\_\_ Areas of Significance—Check and justify below

Specific dates \_\_\_\_\_ Builder/Architect \_\_\_\_\_

Statement of Significance (in one paragraph)

- ☐ summary paragraph
- ☐ completeness
- ☐ clarity
- ☐ applicable criteria
- ☐ justification of areas checked
- ☐ relating significance to the resource
- ☐ context
- ☐ relationship of integrity to significance
- ☐ justification of exception
- ☐ other

## **9. Major Bibliographical References**

## **10. Geographical Data**

Acreage of nominated property \_\_\_\_\_

Quadrangle name \_\_\_\_\_

USGS References

Verbal boundary description and justification

## **11. Form Prepared By**

## **12. State Historic Preservation Officer Certification**

The evaluated significance of this property within the state is:

☐ national ☐ state ☐ local

State Historic Preservation Officer signature

Title \_\_\_\_\_ date \_\_\_\_\_

## **13. Other**

- ☐ Maps
- ☐ Photographs
- ☐ Other

Questions concerning this nomination may be directed to \_\_\_\_\_

Signed \_\_\_\_\_ Date \_\_\_\_\_ Phone: 202 272-3504

Comments for any item may be continued on an attached sheet



CHAPEL HOUSE  
Detail of front  
door

Historic Resources of  
Guilderland (Phase I)  
Guilderland, New York  
Albany County

Building #1



Detail of exposed  
framing



Detail of window  
north side

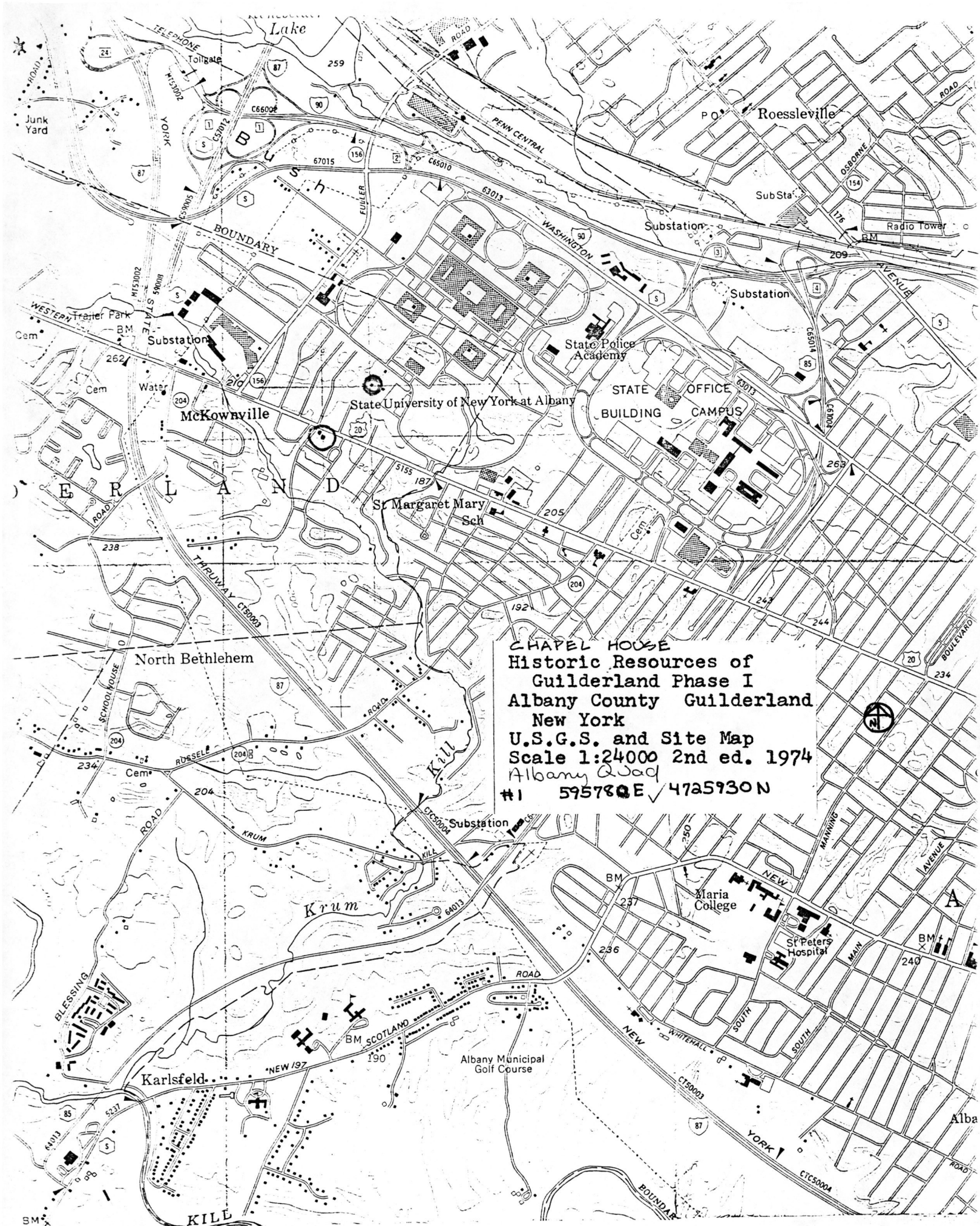

CHAPEL HOUSE  
Historic Resources of  
Guilderland Phase I  
Albany County Guilderland  
New York  
U.S.G.S. and Site Map  
Scale 1:24000 2nd ed. 1974  
Albany Quad  
#1 595780E 4725930N