

BUILDING-STRUCTURE INVENTORY FORM

DIVISION FOR HISTORIC PRESERVATION
NEW YORK STATE PARKS AND RECREATION
ALBANY, NEW YORK (518) 474-0479

FOR OFFICE USE ONLY

UNIQUE SITE NO. 001-06-0141
QUAD _____
SERIES _____
NEG. NO. _____

YOUR NAME: Town of Guilderland DATE: June 1, 1979

YOUR ADDRESS: Town Hall, Guilderland TELEPHONE: 518-356-1980
N.Y.

ORGANIZATION (if any): _____

IDENTIFICATION

1. BUILDING NAME(S): Aumic Residence (Building #33)
2. COUNTY: Albany TOWN/CITY: Guilderland VILLAGE: _____
3. STREET LOCATION: Leesome Ln.; West Side; on Private Rd.
4. OWNERSHIP: a. public ☐ b. private ☒
5. PRESENT OWNER: Donald Aumic ADDRESS: 1704 Bernice St., Schenectady, N.Y. 12303
6. USE: Original: summer residence Present: summer residence
7. ACCESSIBILITY TO PUBLIC: Exterior visible from public road: Yes ☒ No ☐
Interior accessible: Explain by appointment

DESCRIPTION

8. BUILDING MATERIAL: a. clapboard ☐ b. stone ☐ c. brick ☐ d. board and batten ☐
e. cobblestone ☐ f. shingles ☒ g. stucco ☐ other: _____
9. STRUCTURAL SYSTEM (if known): a. wood frame with interlocking joints ☐
b. wood frame with light members ☒
c. masonry load bearing walls ☐
d. metal (explain) _____
e. other _____
10. CONDITION: a. excellent ☐ b. good ☒ c. fair ☐ d. deteriorated ☐
11. INTEGRITY: a. original site ☒ b. moved ☐ if so, when? _____
c. list major alterations and dates (if known): _____

12. PHOTO:



13. MAP:

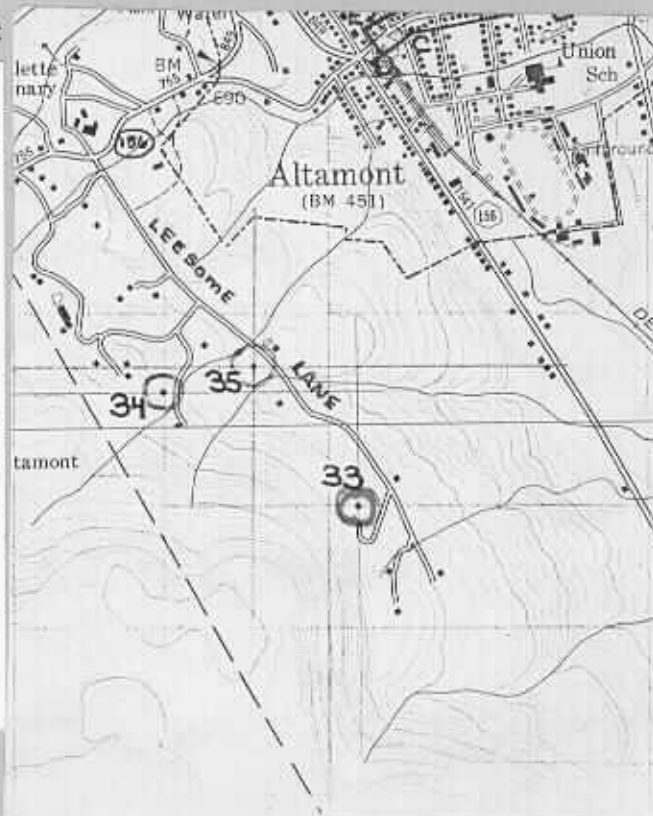

14. THREATS TO BUILDING: a. none known ☒ b. zoning ☐ c. roads ☐
d. developers ☐ e. deterioration ☐
f. other: _____

15. RELATED OUTBUILDINGS AND PROPERTY:

- a. barn ☐ b. carriage house ☐ c. garage ☐
d. privy ☐ e. shed ☐ f. greenhouse ☐
g. shop ☐ h. gardens ☐
i. landscape features: _____
j. other: stone storage building

16. SURROUNDINGS OF THE BUILDING (check more than one if necessary):

- a. open land ☒ b. woodland ☒
c. scattered buildings ☒
d. densely built-up ☐ e. commercial ☐
f. industrial ☐ g. residential ☒
h. other: _____

17. INTERRELATIONSHIP OF BUILDING AND SURROUNDINGS:

(Indicate if building or structure is in an historic district)

The house is located half-way up the side of the Helderberg escarpment and has a commanding view of Altamont and the area east.

18. OTHER NOTABLE FEATURES OF BUILDING AND SITE (including interior features if known):

A massive composite style home with Shingle and Colonial Revival Style influences; hipped roof with gables and dormers; paired windows; one-story porch with wide, rounded arches and balcony with hipped roof over center entrance.

SIGNIFICANCE

19. DATE OF INITIAL CONSTRUCTION: 1887

ARCHITECT: Unknown

BUILDER: Unknown

20. HISTORICAL AND ARCHITECTURAL IMPORTANCE:

Near the turn of the century Altamont became a popular summer retreat and many substantial homes were built on and around the Helderberg escarpment. The house remains unaltered and in excellent repair. Its design, emphasizing symmetry and repeated architectural elements, was clearly influenced by classical styles. Its details, such as the repeated wide arch, bargeboard and exterior cross-hatch boarding, contribute to the stately character of the building. Situated atop an open hill, on the edge of the wooded Helderberg escarpment, the building reflects the growth of Guilderland as a resort town, home to massive summer estates such as this. Modern suburban development is encroaching upon the town; relative to this surrounding the estate displays considerable architectural significance.

21. SOURCES: See bibliography

22. THEME:

Historic Resources of
Guilderland (Phase I)
Guilderland, New York
Albany County

Aumic Residence

Northwest elevation



Southwest elevation



View from house looking
northeast



Historic Resources of
Guilderland (Phase I)
Guilderland, New York
Albany County

Building #33
Aumic Residence

Detail of porch arches



MAY • 30

Stone out building to
the west of house



MAY • 30

Aumic
Leesome Lane

Building # 33

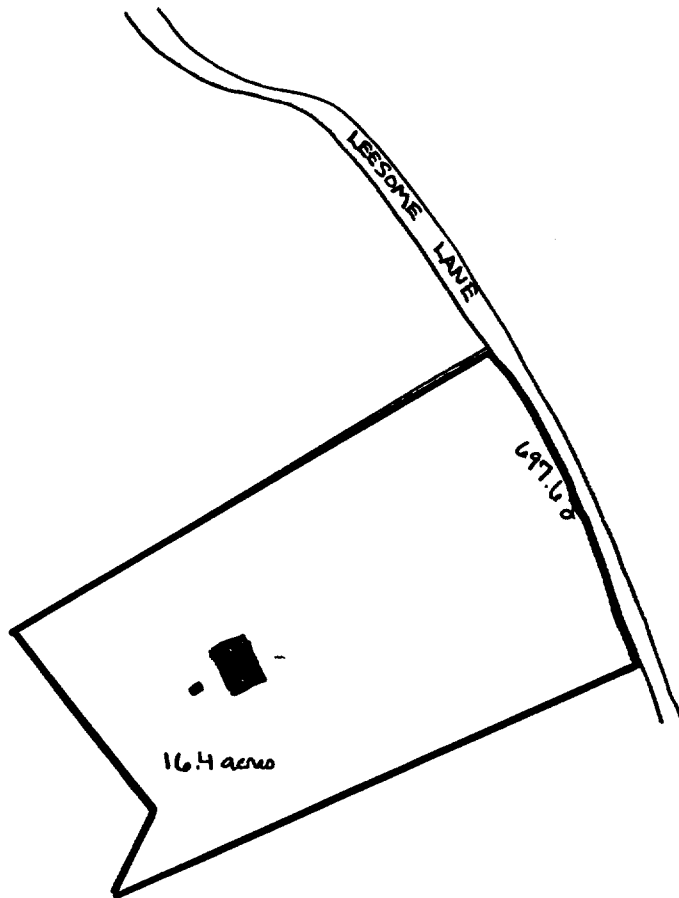

Aumic Residence

Historic Resources of
Guilderland Phase I
Albany County Guilderland
New York
Site Map (from tax map)
Smith & Mahoney 1979

N ↑

1" = 400'

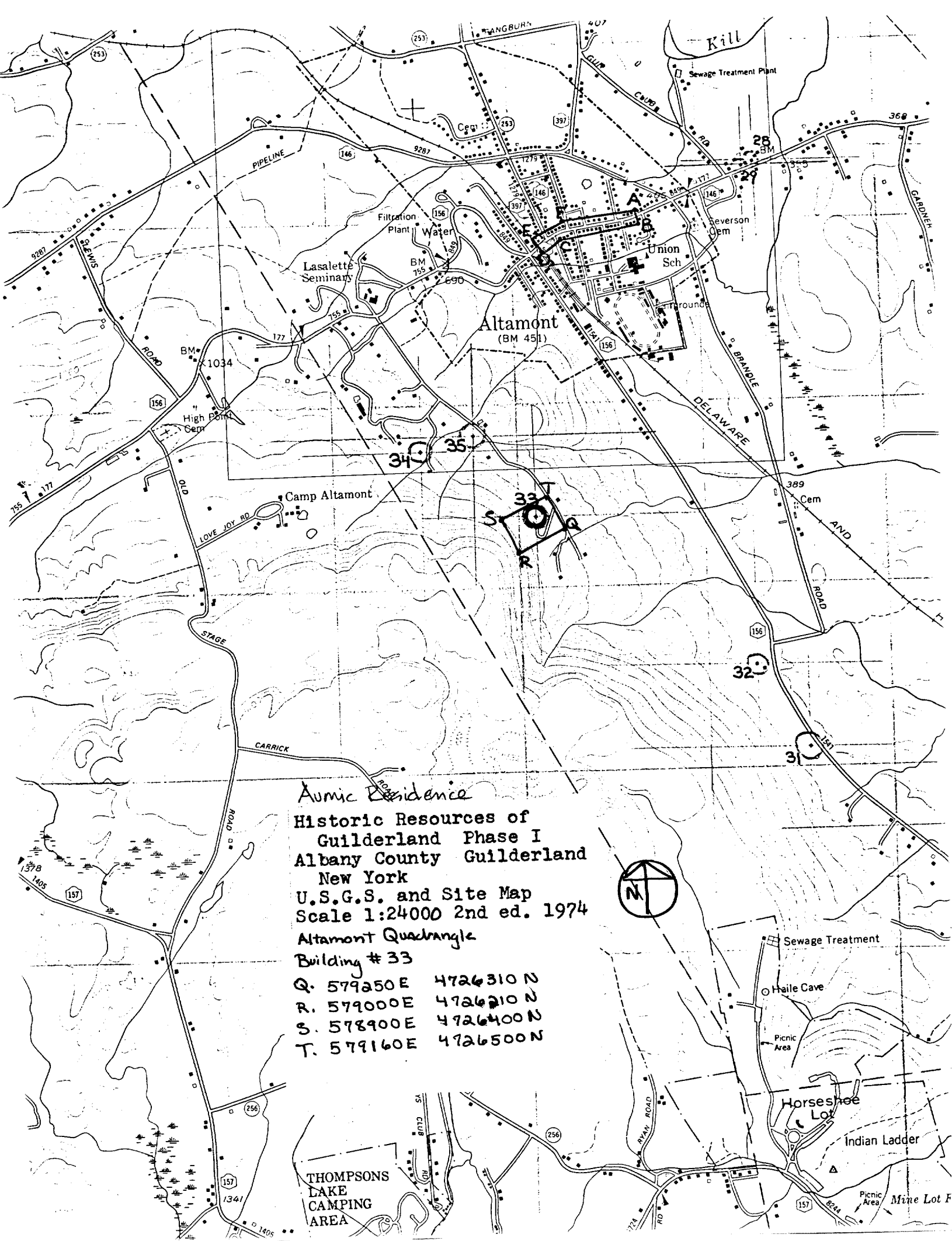

Arctic Residence
**Historic Resources of
Guilderland Phase I
Albany County Guilderland
New York
U.S.G.S. and Site Map
Scale 1:24000 2nd ed. 1974
Altamont Quadrangle**

Building # 33

Q. 579250 E	4726310 N
R. 579000 E	4726210 N
S. 578900 E	4726400 N
T. 579160 E	4726500 N



THOMPSONS
LAKE
CAMPING
AREA

Horseshoe
Lot

Indian Ladder

Mine Lot F