

Adirondack Northway

Stuyvesant Plaza (Tower) (13.4A)

McKownville Water District property and easement reductions

1949 deed - 9.51 acres (but included NiMo land!)
actual area - 8.4 acres

1959 - Stuyvesant entrance - 0.25A - \$5500

1969 - NiMo - 0.42 acres

1970 - Tower & W area parking - 1.52A - \$1

2007 - underground electrical utility - \$1

2009 - parking, trash handling in/egress - \$1 - 0.51A

2012 - parking - 0.05A - \$1



McKownville Water District failed sales attempts

1962 - 1.15 acres - north east side of reservoir
for dept store (\$10,000 offered)

1973 - 0.6 acre - west of NiMo power line
for movie theater (\$2500 offered)

Stuyvesant Plaza (20.5A + 0.5A)

McKownville Water District

4.17A park
6.65A total
5.3756A residue

McKownville Reservoir Park funding sources

2006 - \$99,000 - NY Office of Parks
2009 - \$600,000 - NY Office of Parks (\$100K)
NY DOT (\$200K); Stuyvesant Plaza (\$100K)
NY Assembly/MModal/Capital Programs (\$200K)

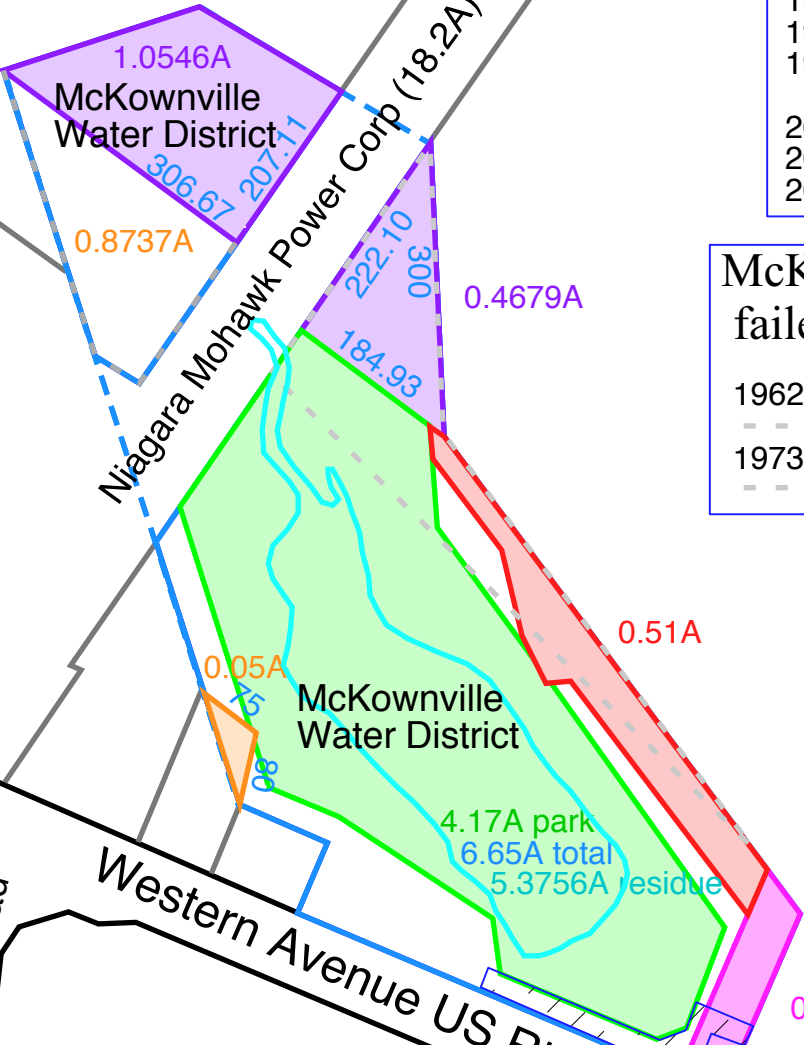

Niagara Mohawk Power Corp (18.2A)

Schoolhouse Road

Western Avenue US Rte 20

E Highland Drive

Fuller Road